

SonicWall® TZ380

SonicWall® TZ380W

SonicWall® TZ480

Quick Start Guide

For product information, go to SonicWall Technical Documentation for the TZ series: sonicwall.com/support/technical-documentation.

Regulatory Model Number	Product Name
APL72-120	TZ380
APL72-121	TZ380W
APL72-120	TZ480



Copyright © 2025 SonicWall Inc. All rights reserved.

SonicWall is a trademark or registered trademark of SonicWall Inc. and/or its affiliates in the U.S.A. and/or other countries. All other trademarks and registered trademarks are property of their respective owners.

The information in this document is provided in connection with SonicWall Inc. and/or its affiliates' products. No license, express or implied, by estoppel or otherwise, to any intellectual property right is granted by this document or in connection with the sale of SonicWall products. EXCEPT AS SET FORTH IN THE TERMS AND CONDITIONS AS SPECIFIED IN THE LICENSE AGREEMENT FOR THIS PRODUCT, SONICWALL AND/OR ITS AFFILIATES ASSUME NO LIABILITY WHATSOEVER AND DISCLAIMS ANY EXPRESS, IMPLIED OR STATUTORY WARRANTY RELATING TO ITS PRODUCTS INCLUDING, BUT NOT LIMITED TO, THE IMPLIED WARRANTY OF MERCHANTABILITY, FITNESS FOR A PARTICULAR PURPOSE, OR NON-INFRINGEMENT. IN NO EVENT SHALL SONICWALL AND/OR ITS AFFILIATES BE LIABLE FOR ANY DIRECT, INDIRECT, CONSEQUENTIAL, PUNITIVE, SPECIAL OR INCIDENTAL DAMAGES (INCLUDING, WITHOUT LIMITATION, DAMAGES FOR LOSS OF PROFITS, BUSINESS INTERRUPTION OR LOSS OF INFORMATION) ARISING OUT OF THE USE OR INABILITY TO USE THIS DOCUMENT, EVEN IF SONICWALL AND/OR ITS AFFILIATES HAVE BEEN ADVISED OF THE POSSIBILITY OF SUCH DAMAGES. SonicWall and/or its affiliates make no representations or warranties with respect to the accuracy or completeness of the contents of this document and reserves the right to make changes to specifications and product descriptions at any time without notice. SonicWall Inc. and/or its affiliates do not make any commitment to update the information contained in this document.

Legend

WARNING: A WARNING icon indicates a potential for property damage, personal injury, or death.

CAUTION: A CAUTION icon indicates potential damage to hardware or loss of data if instructions are not followed.

IMPORTANT, NOTE, TIP, MOBILE, OR VIDEO: icon indicates supporting information.

To access the Support Portal, go to sonicwall.com/support.

SonicWall TZ380 / TZ380W / TZ480 Quick Start Guide
Updated - June 2025
232-006277-52 Rev A



Package Contents



1 TZ series appliance	2 Antennas (2) (wireless models only)
3 12VDC/60W Power adapter	4 Power cord (1) (See note.)
5 Ethernet Cable	6 Screws (2) M3 x 4mm
7 DIN bracket	8 SonicWall TZ series Quick Start Guide
9 Safety, Regulatory and Legal Information document	10 Safety, Environmental, and Regulatory Information document

NOTE: The included power cord is approved for use only in specific countries or regions. Before using a power cord, verify that it is rated and approved for use in your location. The power cord is for AC mains installation only. Refer to the *Safety, Regulatory, and Legal Information* document for the minimum power cord rating and additional safety information.

メモ: 添付の電源コードに関して電気安全を確保するために、弊社製品にご使用いただく電源コードは必ず製品同梱の電源コードをご使用ください。この電源コードは他の製品では使用できません。

Content missing? Contact SonicWall Technical Support at: sonicwall.com/support/contact-support.

Front Panel

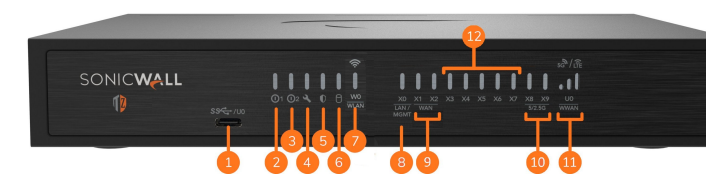

1	USB-C SS 3.0 Port: For uses including configuration, recovery, and USB cellular modem
2	Power LED: Blue = Powered on, Amber = Defective power supply or not connected to AC power, Off = no power adapter detected
3	Power LED: Blue = Powered on, Amber = Defective power supply or not connected to AC power, Off = no power adapter detected
4	Test LED: blinking/solid Amber = initializing or SafeMode
5	Security LED: Green = All security services licensed, blinking Amber = Security services license expired Security Services monitored by this LED: Gateway Anti-Virus, Intrusion Prevention, Anti-Spyware
6	Storage LED: solid Green = Extended Storage module present, blinking Green = Activity, Amber = Storage warning
7	Wireless W0 WLAN LED: (wireless models only) solid Green = Wireless radio is Active, blinking Green = Activity
8 X0	LAN/MGMT X0 Port LED: Solid Green = link up, blinking Green = link activity
9 X1 / X2	WAN X1 and X2 Port LEDs: solid Green = link up, blinking Green = link activity
10 X8 / X9	SFP/SFP+ Port LEDs: solid Green = link up (1 Gbps or less), blinking Green = link activity, solid Amber = link up (2.5 Gbps or higher), blinking Amber = link activity
11	U0 WWAN LEDs for USB 5G/LTE: Green = 5G/LTE signal strength
12 X3 - X7	RJ45 Port LEDs: solid Green = link up, blinking Green = link activity

NOTE: Front and rear USB ports cannot be used at the same time.

Back Panel

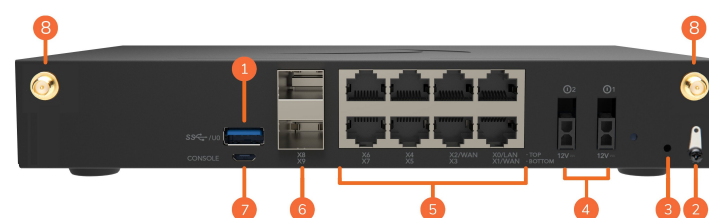

1	USB-A SS 3.0 Port/U0: For uses including configuration, recovery, USB cellular modem, and SonicExpress app connectivity
2	Grounding Screw
3	SafeMode button: Press and hold until the Test LED starts blinking to place the TZ series appliance into SafeMode.
4	Power Inputs: 60W 100~240VAC - 12VDC power adapter A redundant power adapter can be ordered separately.
5 X0 - X7	RJ45 Port: 1 Gbps
6 X8 - X9	SFP/SFP+ Port: 5 / 2.5 / 1 Gbps
7	USB-MicroB Console Port A Micro-USB cable is not provided with the product, but can be ordered separately.
8	Antenna connector: (wireless models only)

NOTE: Front and rear USB ports cannot be used at the same time.

Mounting Options

Flat Surface Option

Place the TZ series appliance on a flat surface. Allow unrestricted airflow around the unit, leaving at least one inch (25.44 mm) clearance on all sides.

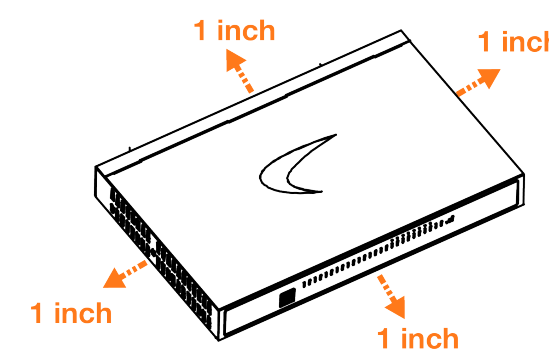

Bracket Mounting Option

Instead of using a rack mount tray to mount your TZ series appliance and power adapter in a standard 19-inch rack, you can mount a DIN bracket to the bottom of your TZ series appliance using the two M3*4mm screws provided and hang it from one of the rails in your rack.

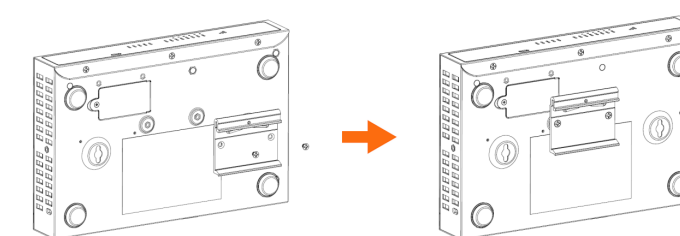

Visit sonicwall.com/products/accessories to order the rack mount for the TZ series appliance.

Rack Mounting Option

SonicWall offers a rack mount tray kit for mounting your TZ series appliance and power adapter in a standard 19-inch rack.

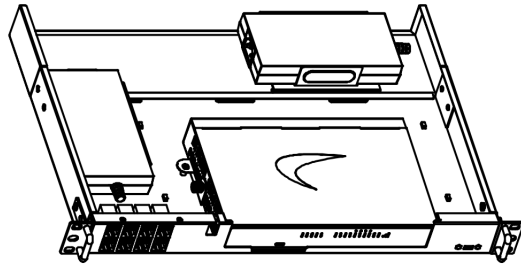

Visit sonicwall.com/products/accessories to order the rack mount for the TZ series appliance.

Connect Power

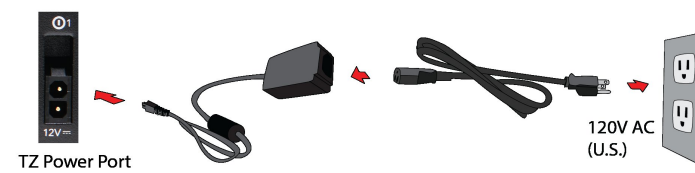

CAUTION: Only use the power adapter cord included with this device. Do not use a power adapter cord that is damaged or from another device.

Connect Interfaces

Connect the WAN interface (X1) on the back of the TZ series appliance to the Internet.

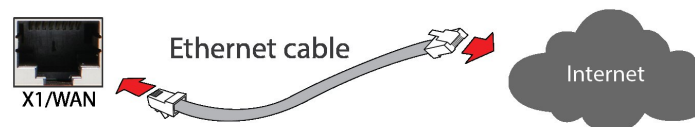

Setup and Registration

Local Management

Set up and manage the TZ series appliance by connecting it to a management computer with an Ethernet cable.

To minimize scrolling, set the screen resolution to at least 1920 x 1080 pixels.

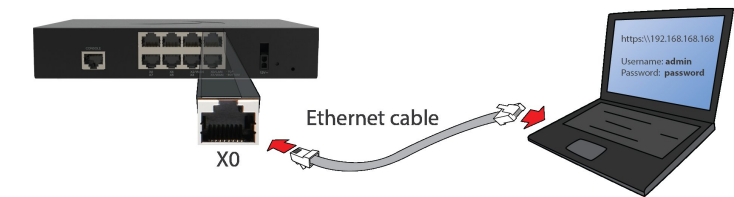

1. Connect the LAN interface (X0) of the TZ series appliance to your computer. (Your computer should be configured to accept DHCP addressing.)
2. Navigate to <https://192.168.168.168> in your web browser and log in with the default credentials:
 - Username: **admin**
 - Password: **password**
3. On successful login using the default password, you are then prompted to change the password.
NOTE: The default password must be changed at the time of your first log in and the new password to be used for future login attempts.
4. Launch the **Setup Guide** wizard or manually configure to complete initial configuration.
5. Click **Register** and log in with your MySonicWall credentials to register the TZ series appliance.

The TZ series appliance is now initialized and ready for use.

Cloud Management

Use SonicWall Capture Security Center (CSC) with Zero Touch to manage and configure the TZ series appliance.

NOTE: This option requires a Cloud Management license and internet connectivity.

1. Log into CSC at cloud.sonicwall.com using your MySonicWall credentials.
2. Select the **MySonicWall** tile to register the TZ series appliance.
3. Enable Zero Touch and NSM licensing on the TZ series appliance in MySonicWall.
4. Select the Network Security Manager tile in CSC to manage the TZ appliance from the cloud.

SonicExpress App

Use SonicWall SonicExpress on an iOS or Android device to register and configure the TZ series appliance.

NOTE: After initial setup, be sure to download the latest firmware from MySonicWall and upgrade the TZ series appliance.

1. Download and launch the SonicExpress App on your iOS or Android device.
2. Tap **Login** and log in with your MySonicWall credentials, then select the tenant for the TZ series appliance. Tenants can contain multiple SonicWall appliances.
3. Connect your iOS or Android device to the TZ series appliance with your smartphone USB cable (not supplied with the TZ series appliance).



NOTE: Use your mobile device USB cable.

4. Use the SonicExpress **Setup Guide** to register the TZ series appliance, synchronize service licenses, change the password, and configure essential interface settings.