

# Meet your BPC100.

inseego<sup>®</sup>

© 2023 Inseego. All Rights Reserved  
PN 90027151-001 R2

## About your BPC100

### Rear View

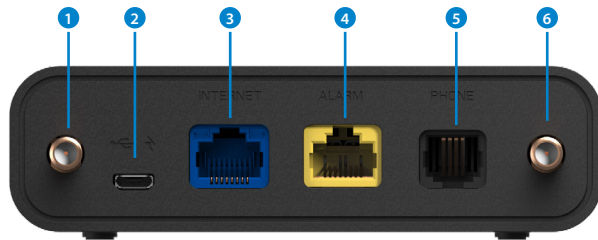

No.	Item	No.	Item
1	External Antenna Connector 1	4	Alarm Port
2	Power Connector Port	5	Phone Port
3	Ethernet Port	6	External Antenna Connector 2

### Top View

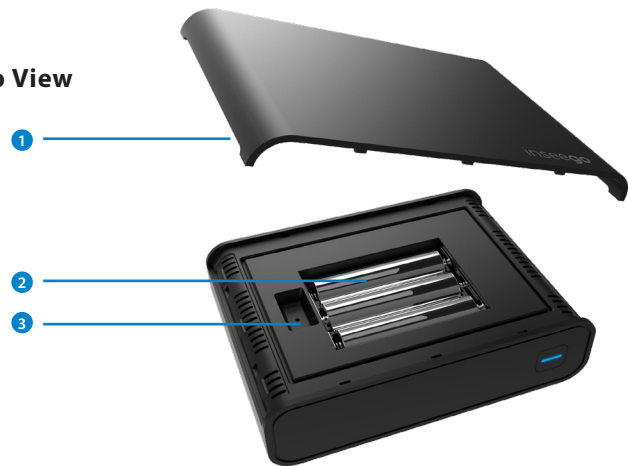

No.	Item
1	BPC Battery Cover
2	3 AA Backup Batteries
3	Reset button

Note: Never place a USB-based device into the power connector port of the BPC100.  
Doing so may damage the device and negate its warranty.

## Setting up your BPC100

Your BPC100 comes with the SIM card installed.

### Step 1: Install backup batteries for use during power outage



1. Open the battery cover.
2. Insert three (3) AA batteries.
3. Close the battery cover.

### Step 2: Install the antennas

To increase signal strength, you can install the two (2) antennas included.

1. Align antennas with the antenna ports and screw securely into place.
2. Restart the BPC100 after the antennas are inserted or removed.

### Step 3: Install the power adapter

1. Insert the power adapter into the power connector port.
2. Plug the power adapter into a wall outlet.



### Step 4: Connect your telephone to the BPC100

The BPC100 provides one port for the telephone.

1. Unplug telephone that you want to use with the BPC100 from the wall telephone jack.

**Warning:**

If your existing phone has rotary or pulse dialing, it will not work with this product.

2. Plug the end of your telephone cord into the PHONE port on the back of your BPC100 (the other end of the cord must remain plugged into the back of your telephone base unit).
3. For best results, place on a firm, flat surface. If your BPC100 needs to be mounted on a wall, please use double-sided mounting tape.

### Step 5: Turn on your BPC100

Press the Power button on the front of the device to turn on the BPC100.

The power indicator will be green when device is turned on.

**Important**

Please make sure your BPC100 is located in an area of your business that receives a strong wireless signal.

### Step 6: Make calls

1. Before making a call, please listen for a dial tone on your telephone. If the indicator light on your BPC100 is blinking red, move the BPC100 to a location that receives a signal or try installing the optional antenna for greater signal strength.
2. Place a call to start using the service.

**Important**

Customers may need to use the three-digit area code when dialing local and long distance numbers. The BPC100 does not support fax machines.

### Find more information

- Contact your service or reseller for customer support.

Go to <http://my.bpc100> for additional information on BPC100 settings and software updates.

The BPC User Guide can be found at:

<https://inseego.com/resources/product-documentation/>