

## Flexible Pipe Kit Installation ACAC10011, ACAC10012, ACAC10013, ACAC10016, ACAC10017, ACAC10029

### Flexible Pipe Kit Specifications

SKU	Inside Diameter	Length	Used On
ACAC10011	1.25 in. (32 mm)	3 ft (0.9 m)	
ACAC10012	1.25 in. (32 mm)	6 ft (1.8 m)	InRow ACRC300 series
ACAC10013	1.25 in. (32 mm)	8 ft (2.4 m)	
ACAC10016	1.50 in. (38 mm)	3 ft (0.9 m)	InRow ACRC500 series and ACRP500 series
ACAC10017	1.50 in. (38 mm)	6 ft (1.8 m)	
ACAC10029	0.5 in. (13 mm)	9 ft (2.7 m)	InRow ACRD100 Series

**NOTE:** Connections between equipment and piping are the same for all piping configurations. A top piping installation is shown. Refer to the submittal drawings for other configurations.

**NOTE:** ACAC10029 is only used in top piping applications.

**NOTE:** See the insulation thickness table for recommendations based on ambient conditions and coolant line temperatures.

### Tools Required

Two 75-mm (3-in.) Adjustable Wrenches

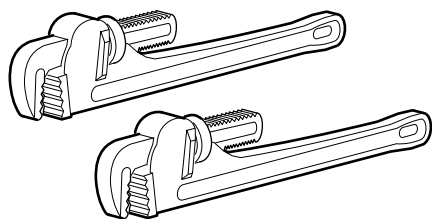

Liquid Dish Soap



### Inventory

- Flex hoses

# Installation

## NOTICE

### DAMAGE TO EQUIPMENT

- Do not torque, over-bend, stretch, or compress hoses.
- Avoid sharp edges or rubbing. The braid is for hose strength, not protection.
- Ensure that the bends in flexible pipes are not under the minimum bend radius.
- Apply wrenches to the fittings only, not hose or weld ferrule.
- Do not alter pipe lengths: install at dimensions indicated on submittal drawings.
- For ACAC10029, exposure to temperatures greater than 538°C (1000°F) may damage internal expansion joints. Use cold strapping or other heat sink procedures to avoid exposure to temperatures exceeding 538°C (1000°F).

**Failure to follow these instructions can result in equipment damage.**

## InRow RC 300 Series

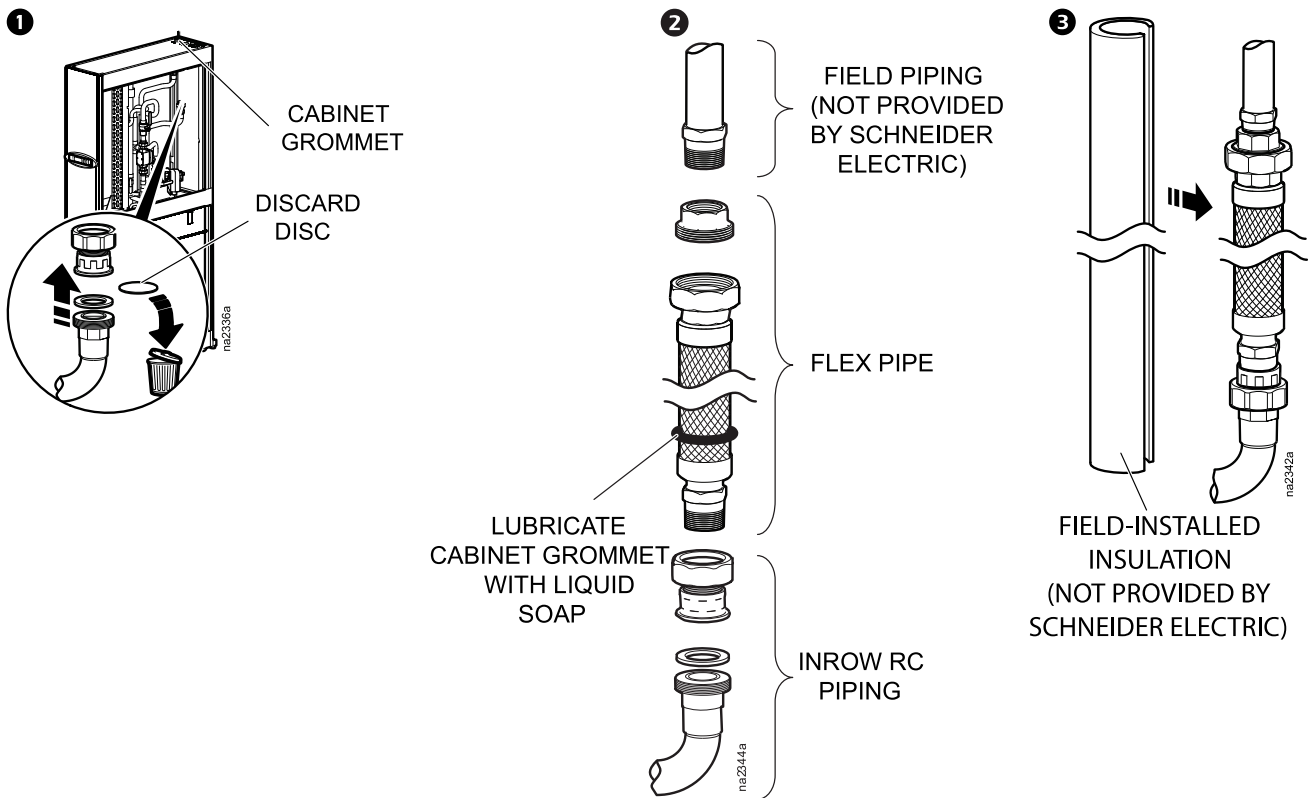

## InRow RC/RP 500 Series

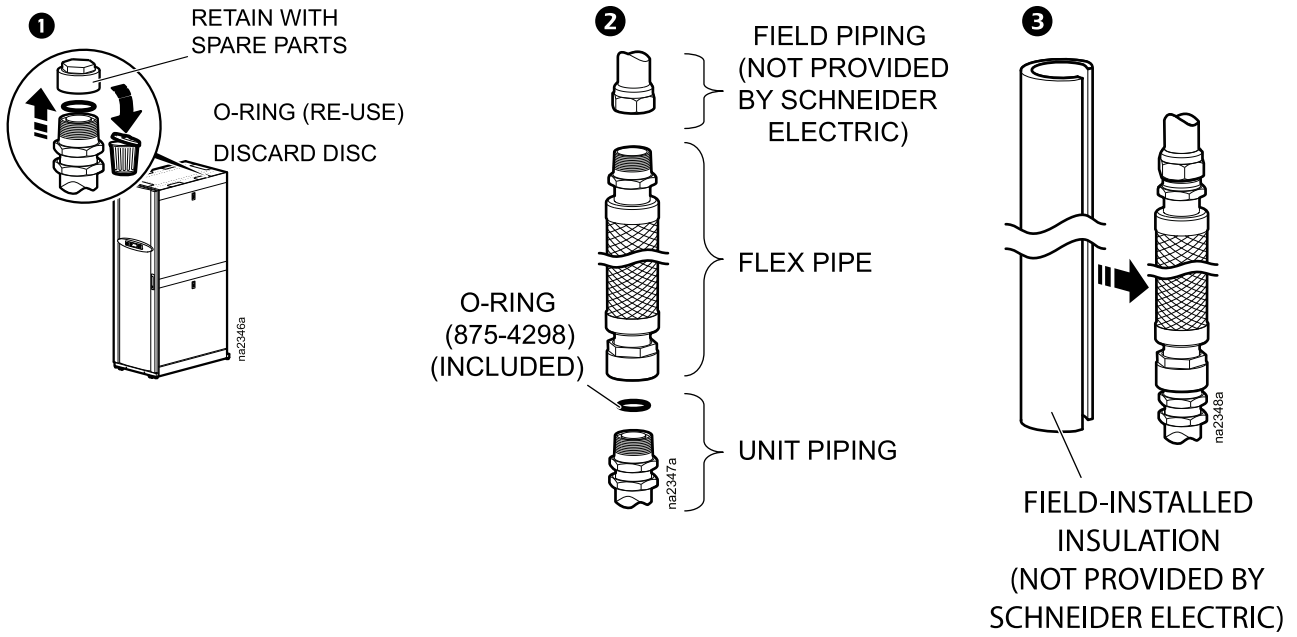

## InRow RD 100 Series

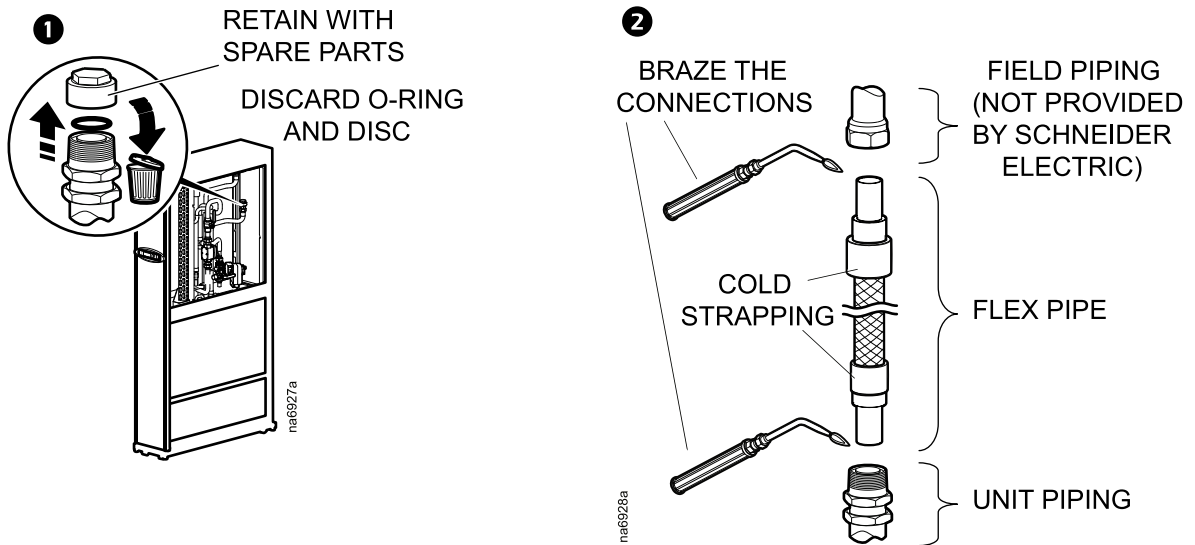

# Proper Hose Installation Guidelines

- Ensure all hoses are connected as shown in the **Correct** column at right.
- Install hoses so all bends are in the same plane.
- Install hoses so flexing takes place in the same plane as the bends.
- Observe the minimum center line bend radius for hoses: 15 in. (381 mm) for RC100 series, 18 in. (457 mm) for RC500 series or RP500 series.
- Provide dielectric coupling where applicable to protect dissimilar metals.
- Additional field-supplied components may be required for proper hose installation.
- After installation, insulate hoses (materials not provided by Schneider Electric). Follow insulation manufacturer recommendation for specific application.
- Use hangers as required to support the weight of hoses.
- Installation must comply with all national and local codes.

### Insulation Thickness Recommendation to Control Condensation

	Thickness at Line Temperature	
	10°C (50°F)	2°C (35°F)
<b>Normal Conditions</b> Maximum 29°C (85°F) at 70% RH	3/8 in. (10 mm)	1/2 in. (13 mm)
<b>Severe Conditions</b> Maximum 32°C (90°F) at 80% RH	3/4 in. (19 mm)	1 in. (25 mm)

\*For 1-3/8 in. (35 mm) through 2-1/2 in. (64 mm) ID, Rubatex® “Insul-Tube® 180” pipe insulation (RBX Industries, Inc.) for indoor piping. Follow the respective insulation manufacturer recommendation for specific application.

**NOTE:** Insulation is not needed on ACAC10029 braided pipe. See the ACRD *Installation Manual* for insulation requirements on the return line.

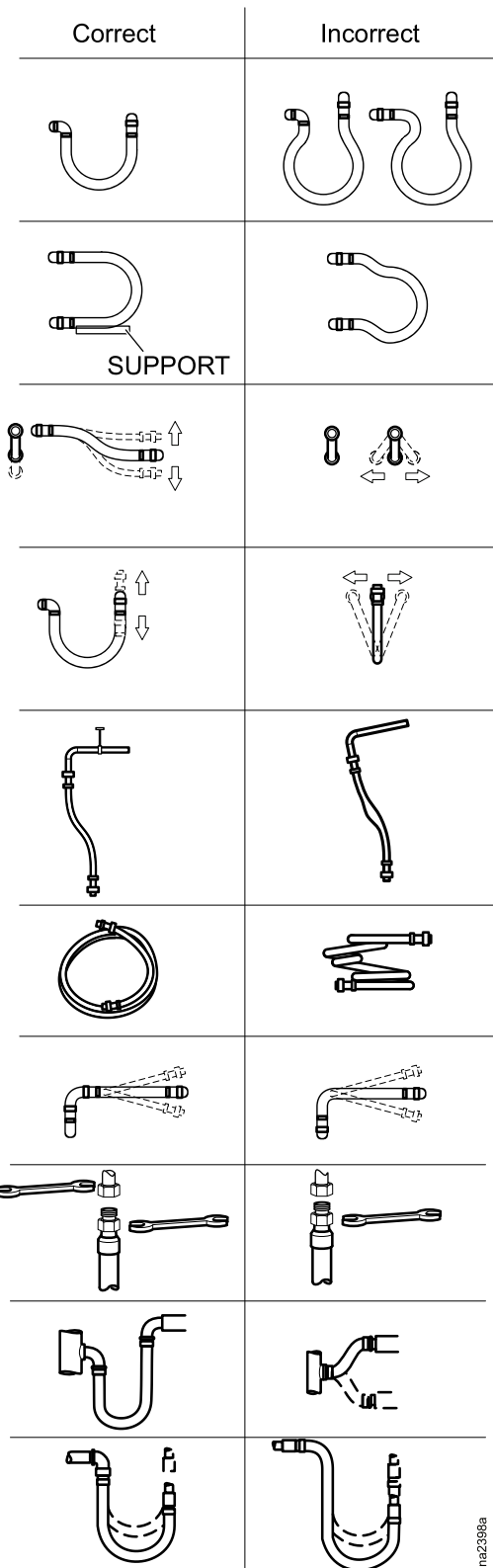

na2398a