

RACK MOUNT READY LCD MONITOR



**17" & 19" TFT-LCD MONITOR
(SECURITY)**

Warning Statements

* Follow this safety instruction to use the monitor properly and prevent the damages.

* This safety instruction has "Warning" and "Caution" as below.

WARNING: If the user does not follow this instruction, it may cause the serious damage to the user.

CAUTION: If the user does not follow this instruction, it may cause the slight damage to the user or cause some damages to the monitor.

* Keep this user's guide book for later use.

Never remove the back over and touch the inside of the monitor. If you need a service, please contact the service center.

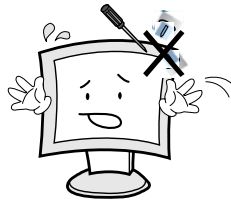

Keep away the monitor from the direct sunlight and a heating appliance.



Never push objects of any kind into this product as they may result in a risk of fire or electric shock.

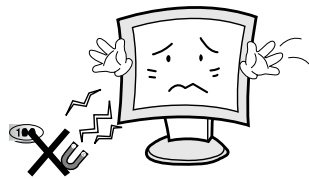

Connect the power code to the wall outlet tightly. If the power code or plug are defective and the wall outlet is not tight, please do not use them.

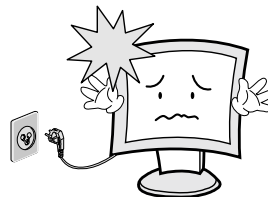

Warning Statements

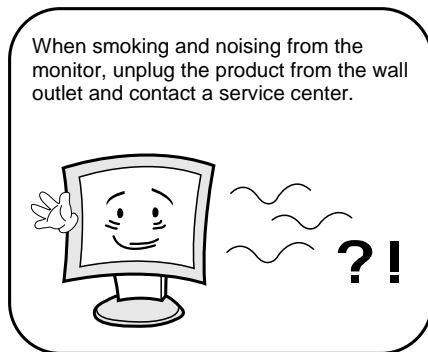
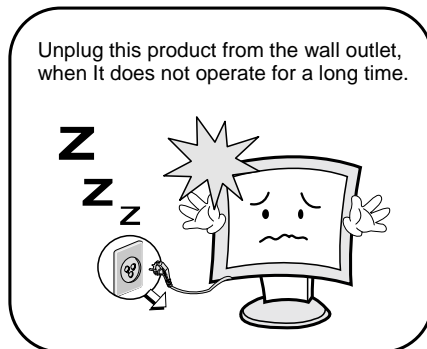
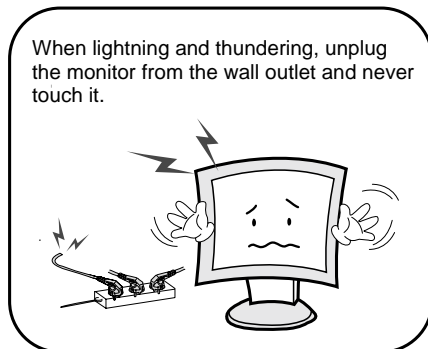
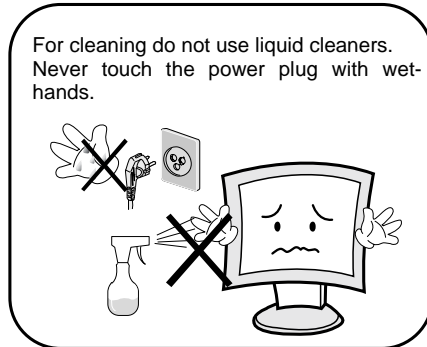
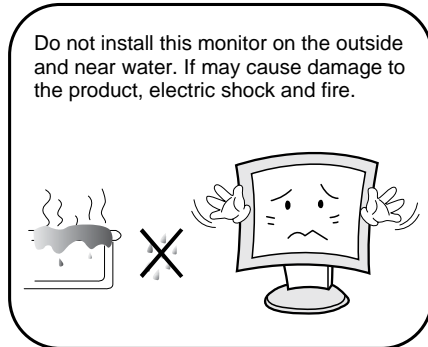

How to fix

1. Do not open this product as it contains high voltage inside.
2. It may create an electric shock.
3. If the user disassembles and remove the back cover, it does not make sure
4. To make up for the damages and do a service and exchange the monitor..

Cautions

Install this monitor some distance
From the wall and do not install unless
Proper ventilation is provided.

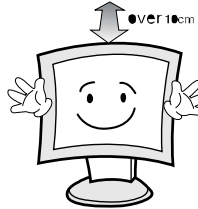

Place this product on a stable place.
If not, it may fall, causing serious
Damages to the monitor and people.



The openings must not be blocked by
curtain, rug or other similar surface.



When carrying this monitor, be careful
not to damage the panel and drop it
It may cause some trouble.

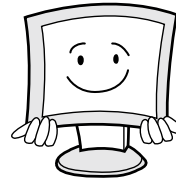

Before carrying the monitor, turn it off
and Unplug the signal cables and the
power cord From the wall outlet.



Take the power plug out from the wall
outlet. Do not pull the cable. It may
snap the inner wires and cause
overheating and fire.

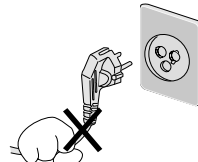

Install this monitor about 50cm far from
the eyes and an angle of 0~15 degrees
below eyes. Too close installation may
cause having weak sight.

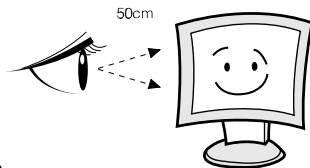

Do not press the LCD panel with hands
or the sharpened material hardly.



For cleaning, unplug the monitor from
the Wall outlet. Do not use the liquid
cloth. Use the soft cloth.

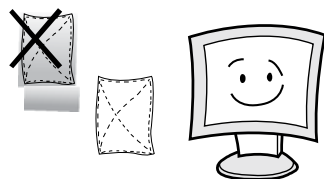

Do not use the chemical liquid for
cleaning. It may cause fading and
breakage.

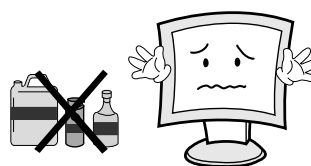

TABLE OF CONTENTS

1. INSTALLATION	6
1.1 Parts	6
1.2 How to Install	7
1.3 Remote Controller	8
2. FEATURES	8
2.1 Specifications	8
3. OSD SETTING	9-13
4. CONTROL BUTTON	14
5. INFORMATION TO THE USER	15
6. TROUBLESHOOTING	16
7. LIMITED LIFETIME WARRANTY	17

INSTALLATION

1.1 Parts

Remove the package cover and place the product on a flat and secure surface or in the installation location. Check whether all the following device and accessories are included with the main system.

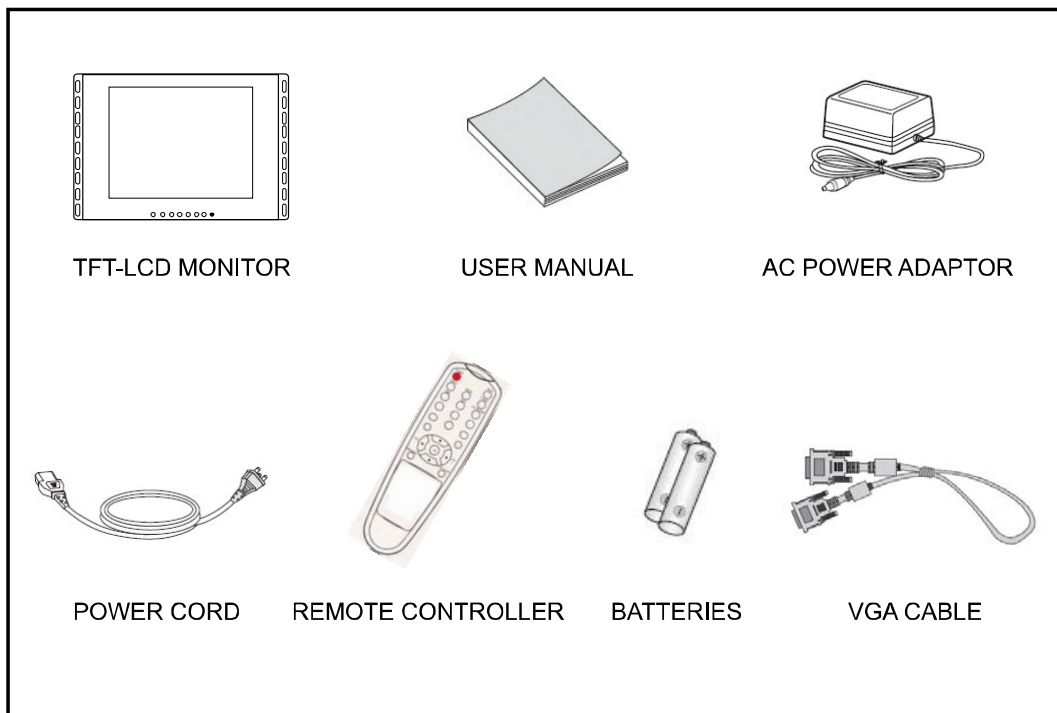

INSTALLATION

1.2 Connection

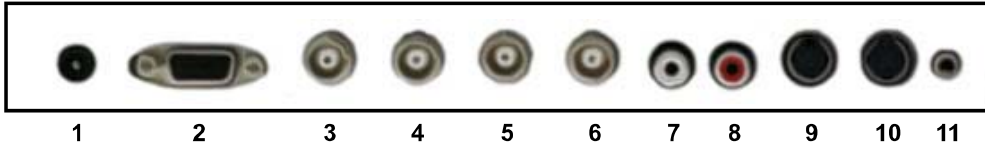

1. **DC 12V IN**
2. **RGB IN**
RGB signal input
3. **VIDEO 1(AV1) IN**
Composite signal input for AV1
4. **VIDEO 1(AV1) OUT**
Video looping output for AV1
5. **VIDEO 2(AV2) IN**
Composite signal input for AV2
6. **VIDEO 2(AV2) OUT**
Video looping output for AV2
7. **AUDIO 1 IN**
Stereo audio signal input. This input is for AV1, S-VIDEO
8. **AUDIO 2 IN**
Stereo audio signal input. This output is for AV2
9. **S-VIDEO (Y/C) IN**
Y/C separated signal input
10. **S-VIDEO (Y/C) OUT**
Y/C separated signal looping output
11. **PC STEREO IN**

INSTALLATION

1.3 Remote Controller

1. **POWER**
Turns the power ON or OFF. There will be a few seconds delay before the display appears.
2. **MUTE**
Mute the sound.
3. **VIDEO1**
Select Video1 source.
4. **VIDEO2**
Select Video2 source.
5. **S-VIDEO**
Select S-Video source.
6. **RGB**
Select RGB source.
7. **AUTO**
Auto geometry adjustment in RGB source.
8. **COLOR TEMP**
Select color temperature.
9. **VOL-/VOL+ (◀▶)**
Increases or decreases the level of audio volume.
10. **UP/DOWN(▲▼)**
Move to OSD menu.
11. **MENU / EXIT**
Activates and exits the On Screen Display.
12. **KEY LOCK**
Prevents unauthorized operation of the equipment by locking the buttons. Key Lock feature by pressing and holding the ▲ and ▼ buttons for five seconds.

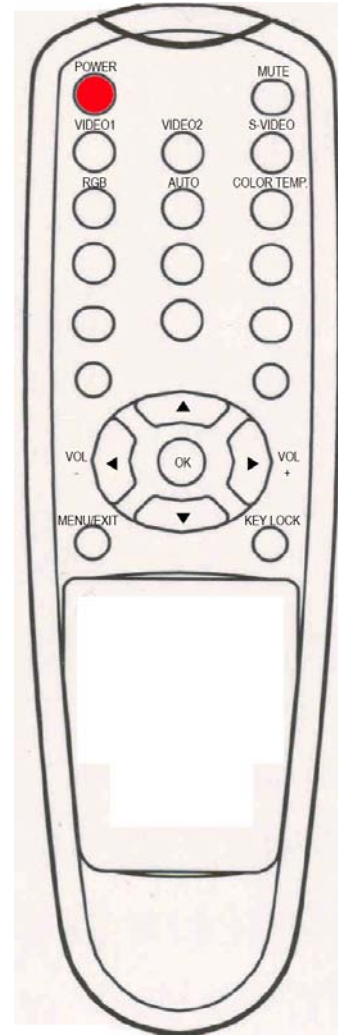

FEATURES

2.1 Specifications (17 & 19 INCH)

VIDEO		
Screen Size	17"	19"
Pixel Type	Active Matrix TFT	
Max. Resolution	1280 x 1024 @ 60Hz (SXGA)	
Pixel Pitch	0.264 x 0.264mm	0.294 x 0.294mm
Brightness	300 cd/m ²	
Contrast Ratio	1000 : 1	
Aspect Ratio	5:4	
Viewing Angle (H/V)	160 / 160	
Display Color	16.7 MILLION	
Response Time	< 5ms	
Video System	NTSC / PAL / SECAM	
Frequency (H)	31 ~ 48KHz	
Frequency (V)	55 ~ 75Hz	
Panel Lamp Life	50,000hours	
MECHANICAL		
Packing Dimension		
W x H x D	20" x 16.1" x 6.5"	
Weight	17.6lbs	19.4lbs
Power Consumption	35W	42W
Power Source	DC12V adapter (Auto Switching) / 3.5A	

NOTE : Technical specifications are subject to change without notice..

OSD (On Screen Display) SETTING

3.1 OSD MENU Description

MENU SELECTION

1. Press the MENU key to access the Main menu.
2. Use the ▲ and ▼ arrow key to highlight a selection
3. Press the OK or ► button to select an item.
4. Use the ▲ and ▼ arrow key to highlight a selection.
5. Use the ◀ and ▶ arrow key to adjust the setting on a selected item.

NOTE : If you don't connect RGB port, RGB SETUP menu is not select.

A. Input Select



Inputs can be set to VIDEO1, VIDEO2, S-VIDEO and RGB mode.

1. Press the SOURCE button and then ▲/▼ button to move the source.
2. Press the ► button to select the source.
3. Press the MENU/EXIT button to exit the INPUT menu.

B. Picture Menu

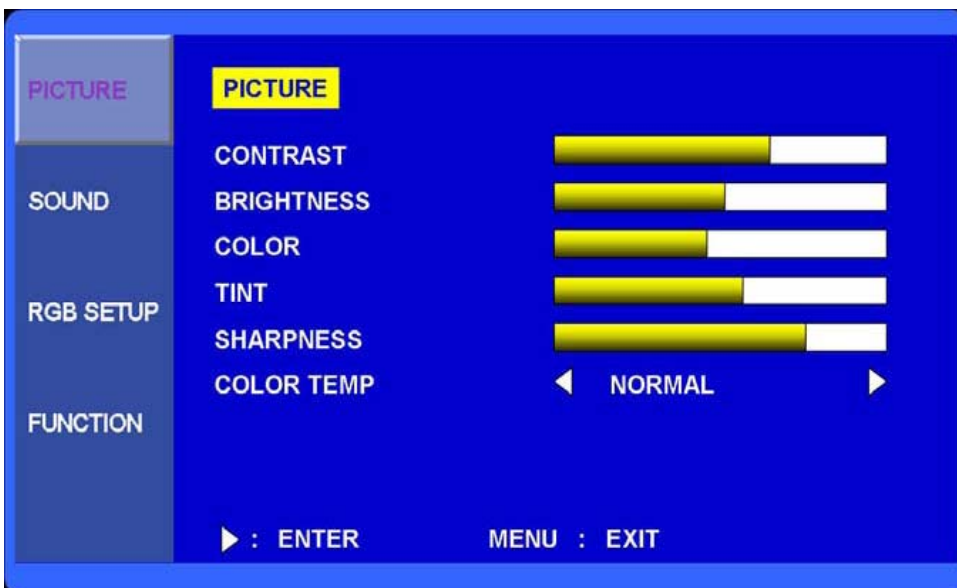

OSD (On Screen Display) SETTING

1. Press the MENU/EXIT key and then ▼/◀ or ▲/▶ key to select the PICTURE menu.
2. Press the OK or ▶ button and then ▲/▶ button to select the adjustment item you need.
3. Press the OK or ▶ button to active the item.

EX) If you select the BRIGHTNESS, then the picture below appears on the screen.



4. Press the MENU/EXIT button to move the previous menu..

NOTE : TINT item is for the NTSC input only.

C. Sound Menu



2. Press the MENU button and then ▲/▼ button to select the SOUND menu.
3. Press the ▶ button and then ▲/▼ button to select the adjustment item you need.
4. Press the ▶ button to active the item.

EX) If you select the TREBLE, then the picture below appears on the screen.



1. Press the MENU button to move to the previous menu..

OSD (On Screen Display) SETTING

D. RGB Setup Menu

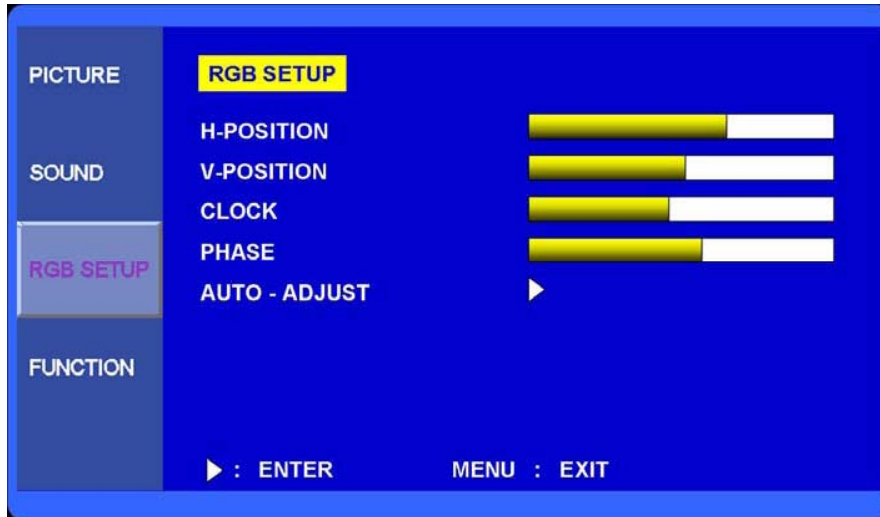

1. Press the MENU button and then ▲/▼ button to select the RGB SETUP menu.
2. Press the ▶ button and then ▲/▼ button to select the adjustment item you need.
3. Press the ▶ button to active the item.
4. Press the MENU button to move to the previous menu.

E. Function Menu



OSD (On Screen Display) SETTING

E. Function Menu (Continue)

5. Press the MENU button and then ▲/▼ button to select the FUNCTION menu.
6. Press the ► button and then ▲/▼ button to select the adjustment item you need.
7. Press the ► button to active the item.
8. Press the MENU button to move to the previous menu.

LANGUAGE : Select the language: English, French, German, Italian, Spanish.
DEAFULT : Select RESET to set the monitor to the factory default values.

CONTROLL BUTTON

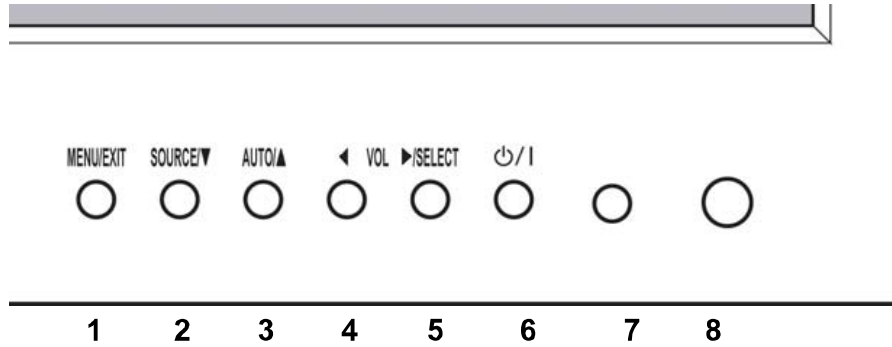

Menu/EXIT: Activates and exits the OSD.

SOURCE/▼: Select input source, and select the OSD menu.

AUTO/▲: Move the OSD menu and auto adjustment of RGB source.

◀ (VOL-): Decreases the level of volume and move the previous menu.

▶/SELECT (VOL+): Increases the level of volume and select the OSD menu.

Power button: Turns the power ON or OFF. There will be a few seconds delay before the display appears.

The power LED(next to the power switch) lights with green when the power is turned ON.

The power is turned off by pressing the power switch again and the power LED goes Red.

LED LENSE:

IR RECEIVE LENSE:

INFORMATION TO THE USER

This equipment has been tested and found to comply with the limits for a Class B digital device, pursuant to part 15 of the FCC Rules. These limits are designed to provide reasonable protection against harmful interference in a residential installation. This equipment generates, uses and can radiate radio frequency energy and, if not installed and used in accordance with the instructions, may cause harmful interference to radio communications. However, there is no guarantee that interference will not occur in a particular installation. If this equipment does cause harmful interference to radio or television reception, which can be determined by turning the equipment off and on, the user is encouraged to try to correct the interference by one more of the following measures:

- Reorient or relocate the receiving antenna.
- Increase the separation between the equipment and receiver.
- Connect the equipment into an outlet on a circuit different from that to which the receiver is connected.
- Consult the dealer or an experienced radio / TV technician for help.

WARNING:

The manufacturer is not responsible for any Radio or TV interference caused by unauthorized modifications to this equipment. Such modifications could void the user's authority to operate the equipment."

TROUBLESHOOTING

* When the following troubles are occurred, follow the trouble shooting. Before contacting a service center.

Troubleshooting	Troubleshooting Tip
The screen doesn't show up	1. Make sure if the power supply is connected property
	2. Turn on the power.
	3. Select the input signal right for the connected port.
The screen is too light or to dark	Control the BRIGHTNESS
The screen size is not fit for the PC signal	Press the AUTO key among keys in the front. (It is used only in the PC signal)
The screen color shows strange in the PC signal	In the FUNCTION menu of OSD menu, perform the AUTO-ADJUST.

2Year Limited Warranty

All **Orion Images** products carry a limited warranty from ship date against defects in materials and workmanship. Orion Images is not liable for improper installation that results in damage to mounts, adapters, display equipment or personal injury.

Contact Orion Images

In the event of missing and/or damage equipment, or technical questions, the following information can help in the completion of the installation.

Address: 7300 Bolsa Avenue, Westminster, CA 92683

Tel: 714-766-6300 / Fax: 714-766-6310

Email: sales@orionimages.com

Website: <http://www.orionimages.com>