

PREMIUM SERIES LCD MONITOR



**17" & 19" TFT-LCD MONITOR
(SECURITY)**

Warning Statements

* Follow this safety instruction to use the monitor properly and prevent the damages.

* This safety instruction has "Warning" and "Caution" as below.

WARNING: If the user does not follow this instruction, it may cause the serious damage to the user.

CAUTION: If the user does not follow this instruction, it may cause the slight damage to the user or cause some damages to the monitor.

* Keep this user's guide book for later use.

Never remove the back over and touch the inside of the monitor. If you need a service, please contact the service center.

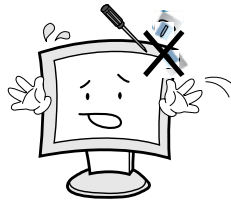

Keep away the monitor from the direct sunlight and a heating appliance.



Never push objects of any kind into this product as they may result in a risk of fire or electric shock.

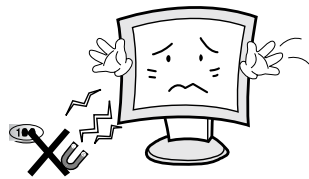

Connect the power code to the wall outlet tightly. If the power code or plug are defective and the wall outlet is not tight, please do not use them.

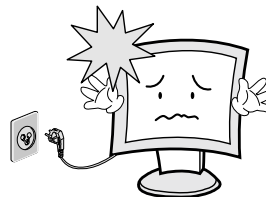

Warning Statements

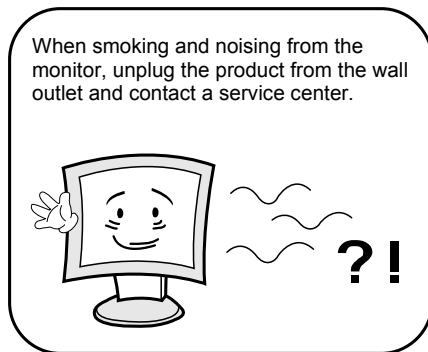
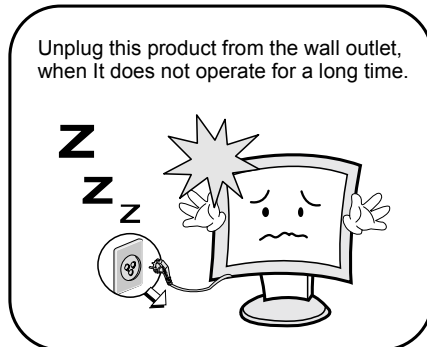
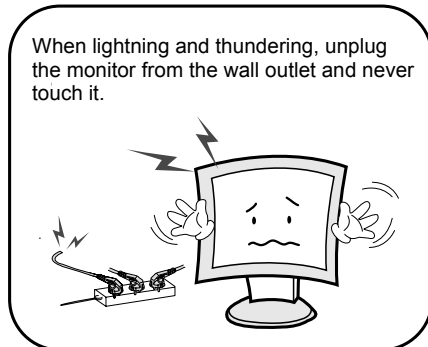
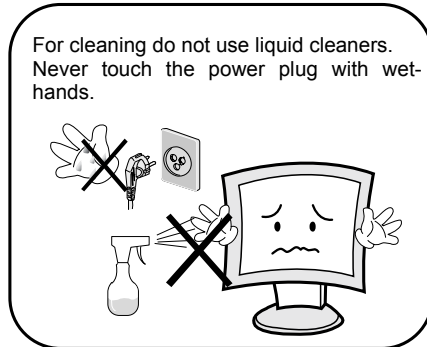
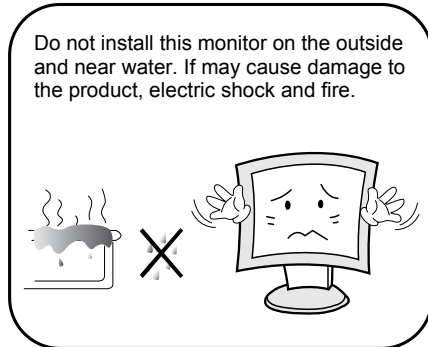

How to fix

1. Do not open this product as it contains high voltage inside.
2. It may create an electric shock.
3. If the user disassembles and remove the back cover, it does not make sure
4. To make up for the damages and do a service and exchange the monitor..

Cautions

Install this monitor some distance
From the wall and do not install unless
Proper ventilation is provided.

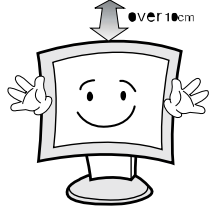

Place this product on a stable place.
If not, it may fall, causing serious
Damages to the monitor and people.



The openings must not be blocked by
curtain, rug or other similar surface.



When carrying this monitor, be careful
not to damage the panel and drop it
It may cause some trouble.

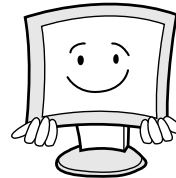

Before carrying the monitor, turn it off
and Unplug the signal cables and the
power cord From the wall outlet.



Take the power plug out from the wall
outlet. Do not pull the cable. It may
snap the inner wires and cause
overheating and fire.

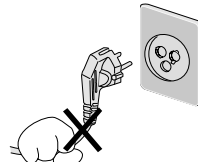

Install this monitor about 50cm far from
the eyes and an angle of 0~15 degrees
below eyes. Too close installation may
cause having weak sight.

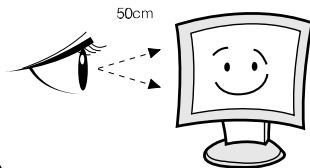

Do not press the LCD panel with hands
or the sharpened material hardly.



For cleaning, unplug the monitor from
the Wall outlet. Do not use the liquid
cloth. Use the soft cloth.

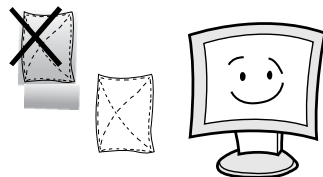

Do not use the chemical liquid for
cleaning. It may cause fading and
breakage.



TABLE OF CONTENTS

1. INSTALLATION	6
1.1 Parts	6
1.2 Connection	7
1.3 Remote Controller	8
2. FEATURES	9
2.1 Specifications	9
3. OSD SETTING	10-14
4. CONTROL BUTTON	15
5. INFORMATION TO THE USER	16
6. TROUBLESHOOTING	17
7. LIMITED LIFETIME WARRANTY	18

INSTALLATION

1.1 Parts

Remove the package cover and place the product on a flat and secure surface or in the installation location. Check whether all the following device and accessories are included with the main system.

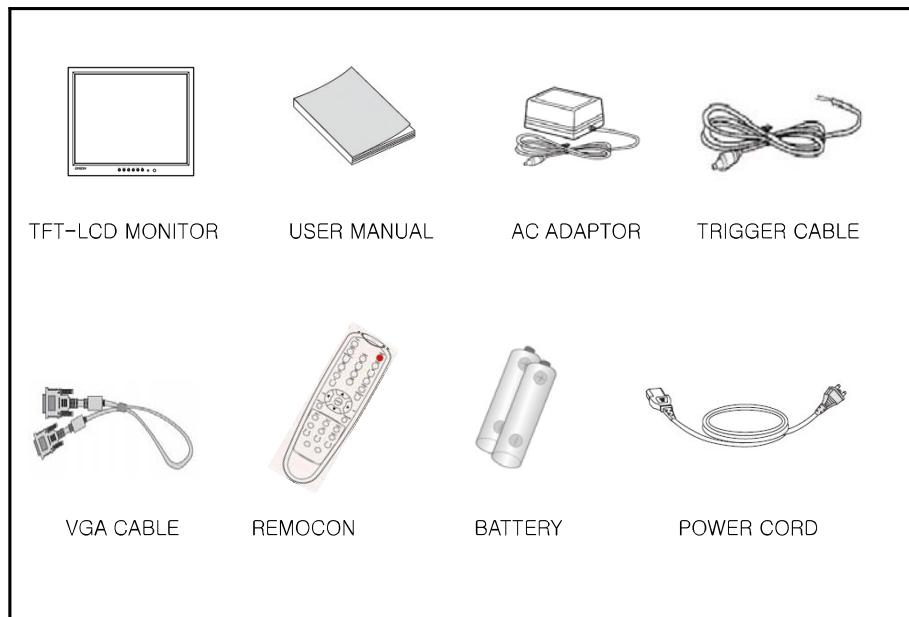

INSTALLATION

1.2 Connection

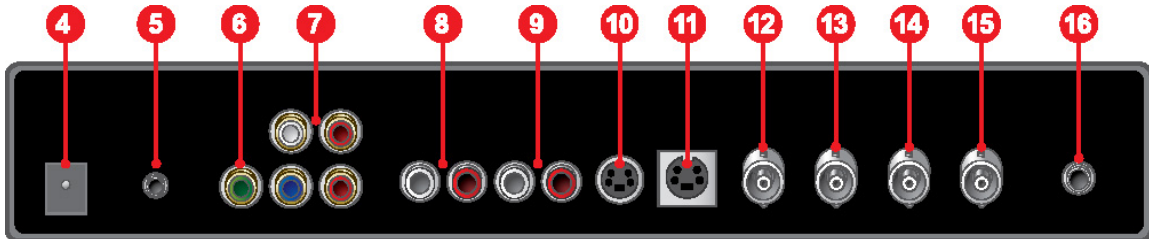

1. **HDMI IN**
2. **DVI IN**
3. **RGB IN**
4. **DC 24V IN**
5. **PC STEREO INPUT**
6. **COMPONENT IN**
YPbPr signal input.
7. **STEREO AUDIO 1 IN**
Component stereo audio signal input.
8. **AUDIO2 IN**
Stereo audio signal input. This input for VIDEO2.
9. **AUDIO1 IN**
Stereo audio signal input. This input for VIDEO1 and S-VIDEO.
10. **S-VIDEO (Y/C) OUT**
Y/C separated signal looping output.
11. **S-VIDEO (Y/C) IN**
Y/C separated signal input.
12. **VIDEO2 OUT**
Video looping output for VIDEO2.
13. **VIDEO2 IN**
Composite signal input for VIDEO2.
14. **VIDEO1 OUT**
Video looping output for VIDEO1.
15. **VIDEO1 IN**
Composite signal input for VIDEO1.
16. **TRIGGER INPUT**
NO / NC signal input.

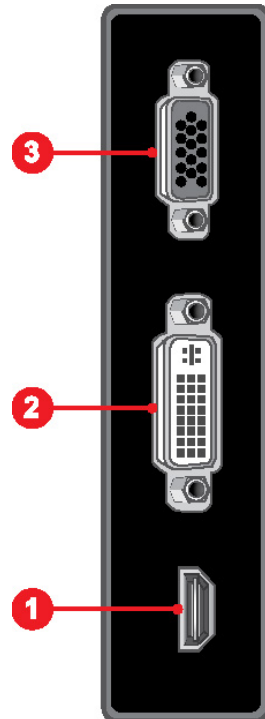

INSTALLATION

1.3 Remote Controller

A. SOURCE SELECT

Press the button to select the desired input source

B. PVM INPUT (Not Available on this Model)

- POWER**
Turn the monitor ON or OFF
- MUTE**
Temporarily silences the sound
- COLOR TEMP**
Adjust the color temperature of the screen.
- SCAN MODE**
Change the scan mode of the screen. (FULL / UNDER / OVER)
- MENU/EXIT**
Activates and exits the OSD menu
- KEY LOCK**
Prevent unauthorized operation of the equipment by locking the buttons
- STILL** PIP: Activates/deactivates PIP/PBP mode

C. PIP MENU

- PIP : Activates/deactivates PIP/PBP mode.
- P. INPUT: Selects an input source for the sub picture
- P. LOC: Selects a location for the sub picture
- P. SIZE : Selects the size of the sub picture.
- P. SWAP : Swaps the main and sub picture.
- P. SET: Alternates between main and sub audio input

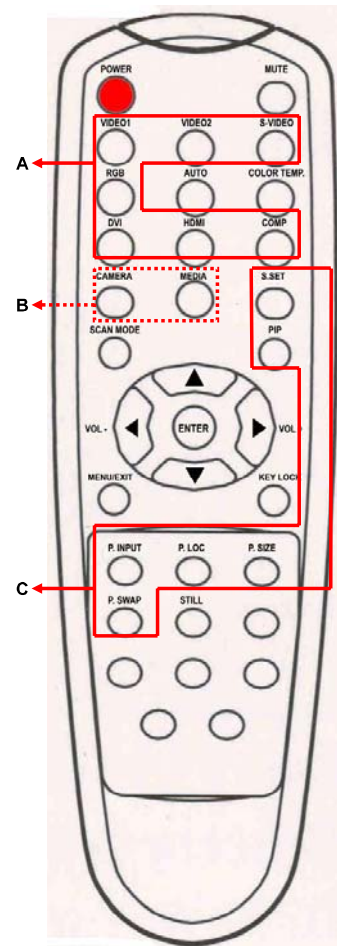

FEATURES

2.1 Specifications (17 & 19 Inch)

VIDEO		
Screen Size	17"	19"
Viewing Area	338.0 x 278.0mm	376.0 x 301.0mm
Pixel Type	Active Matrix TFT	
Max. Resolution	1280 x 1024 @ 60Hz (SXGA)	
Pixel Pitch	0.264 x 0.264mm	0.294 x 0.294mm
Brightness	250 cd/m ²	
Contrast Ratio	800 : 1	
Aspect Ratio	4:3	
Viewing Angle (H/V)	170 / 160	
Display Color	16.7Million	
Response Time	< 5ms	
Video System	NTSC / PAL / SECAM	
Frequency (H)	31 ~ 48KHz	
Frequency (V)	55 ~ 75Hz	
Panel Lamp Life	50,000hours	
MECHANICAL		
Packing Dimension		
W x H x D	20.0" x 16.1" x 6.5"	20.0" x 16.1" x 6.5"
Weight	17.6lbs	19.4lbs
Power Consumption	40W	45W
Power Source	AC100 ~ 240V(50 / 60Hz)	
	DC 12V / 3.5A	DC 12V / 4.1A

NOTE : Technical specifications are subject to change without notice..

OSD (On Screen Display) SETTING

3.1 OSD MENU Description

A. Input Select



Inputs can be set to VIDEO1, VIDEO2, S-VIDEO, RGB PC, DVI, HDM, COMPONENT mode.

1. Press the ▶/SELECT key then you can change the input source...

B. Menu Selection

1. Press the MENU key to access the Main menu.
2. Use the ▲ and ▼ arrow key to highlight a selection
3. Press the ▶/SELECT key to select an item.
4. Use the ▲ and ▼ arrow key to highlight a selection.
5. Use the ◀ and ▶ arrow key to adjust the setting on a selected item.

NOTE : If you don't connect RGB port, RGB SETUP menu is not select.

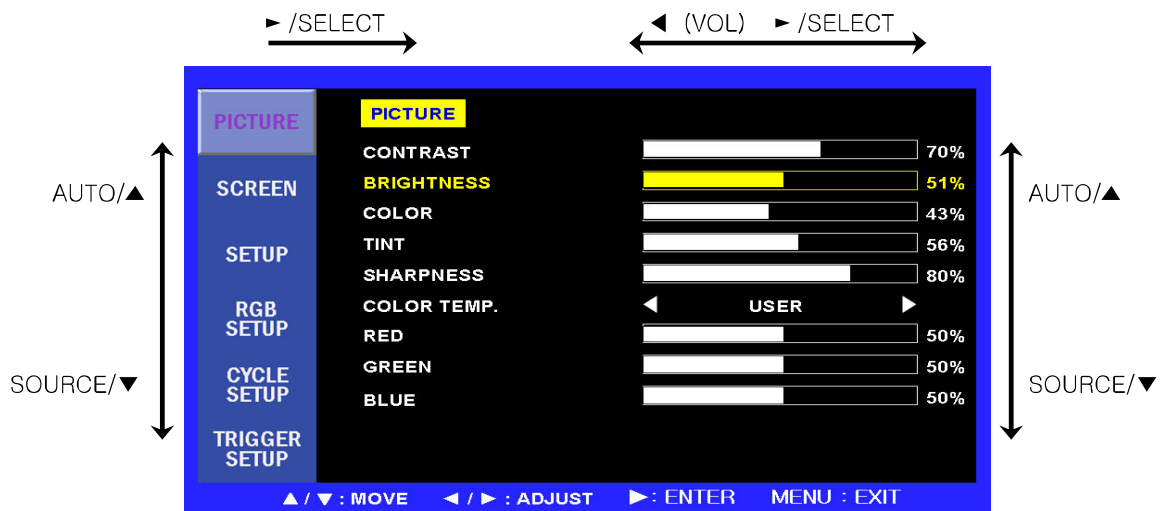

OSD (On Screen Display) SETTING

C. Screen Menu

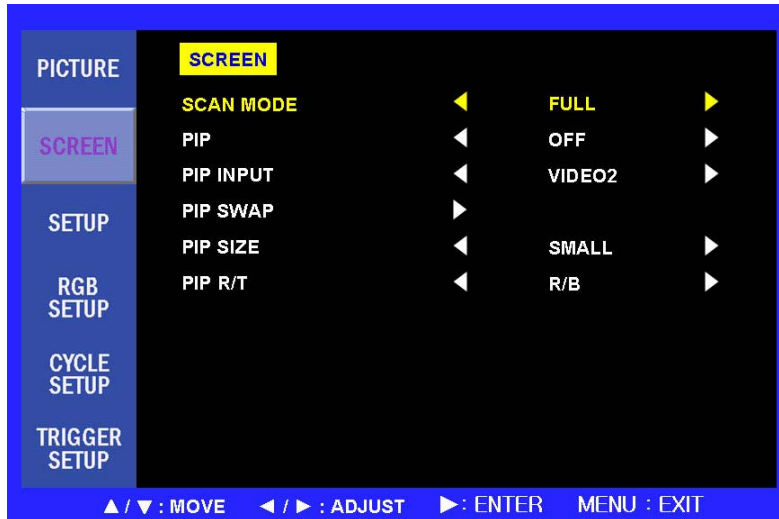

- 1. SCAN MODE**
Select the screen size of main. (FULL / UNDER / OVER)
- 2. PIP**
Select PIP mode. (OFF / ON / DW1 / DW2)
- 3. PIP INPUT**
Select sub input of PIP mode. (VIDEO1 / VIDEO2 / S-VIDEO)
- 4. PIP SWAP**
Select swap to interchange main with PIP
- 5. PIP SIZE**
Select the PIP size. (SMALL / NORMAL / LARGE)
- 6. PIP R/T**
Select the PIP position.
R/B : Right Bottom
L/B : Left Bottom
R/T : Right Top
L/T : Left Top

OSD (On Screen Display) SETTING

D. Setup Menu

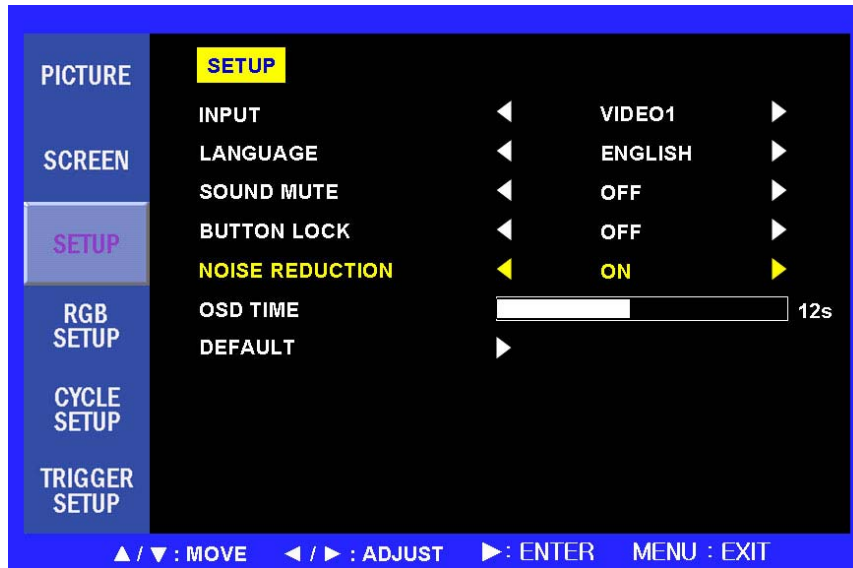

- 1. INPUT**
Select input source. (VIDEO1 / VIDEO2 / S-VIDEO / RGB PC / DVI / HDMI / COMPONENT).
- 2. LANGUAGE**
Select English, Italian, French, Spanish or German for the OSD display.
- 3. SOUND MUTE**
Select OFF or ON. 'ON' silences the sound, 'OFF' return the sound.
- 4. BUTTON LOCK**
Prevents unauthorized operation of the equipment by locking the buttons. Button lock feature by pressing the ◀ and ▲ buttons for 5 seconds.
- 5. NOISE REDUCTION**
Reduces the background noise of the video signal.
- 6. OSD TIME**
Select the OSD display time from 5 seconds to 30 seconds.
- 7. DEFAULT**
Select restore to return to the factory setting.

OSD (On Screen Display) SETTING

E. Trigger Setup Menu

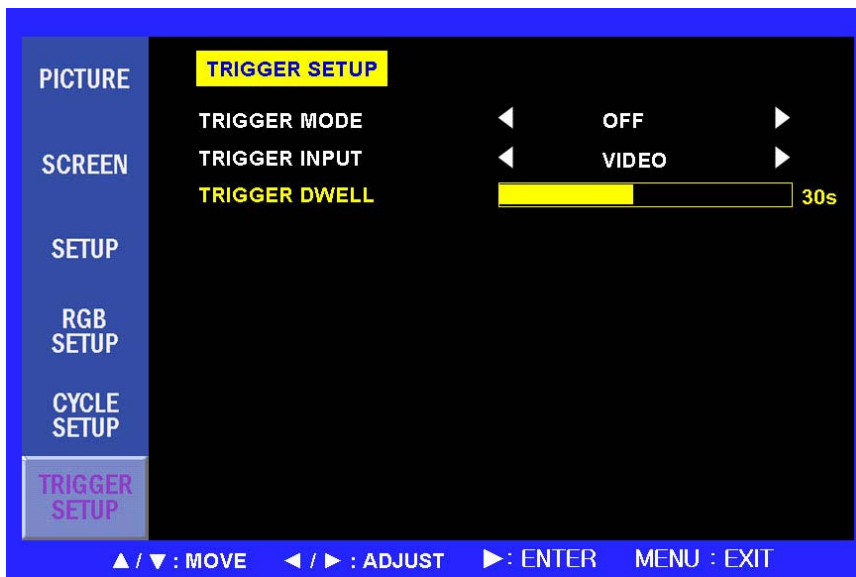

- 1. TRIGGER MODE**
Sets the video input witch will be displayed when trigger signal. (OFF/ FULL / DW1 / DW2)
- 2. TRIGGER INPUT**
Select the input source of trigger mode. (VIDEO1 / VIDEO2 / S-VIDEO).
- 3. TRIGGER DWELL**
Sets the time how long displayed on the screen of trigger mode from 10 seconds to 60 seconds.

OSD (On Screen Display) SETTING

E. Menu Tree

MAIN MENU

**PICTURE
SCREEN
SETUP
RGB SETUP
CYCLE SETUP
TRIGGER SETUP**

PICTURE

CONTRAST
BRIGHTNESS
COLOR
TINT
SHARPNESS
COLOR TEMP. : COOL / MEDIUM / WARM / USER (RED / GREEN / BLUE)

SCREEN

SCAN MODE : FULL / UNDER / OVER
PIP : OFF / ON / DW1 (WIDE PBP) / DW2 (FULL PBP)
PIP INPUT
PIP SWAP
PIP SIZE : SMALL / NORMAL / LARGE
PIP R/T (ROTATION) : R/B (RIGHT BOTTOM)
L/B (LEFT BOTTOM)
L/T (LEFT TOP)
R/T (RIGHT TOP)

SETUP

INPUT : VIDEO1 / VIDEO2 / S-VIDEO / RGB PC / DVI / HDMI / COMPONENT
LANGUAGE : ENGLISH / ITALIAN / FRENCH / SPANISH / GERMAN
SOUND MUTE
BUTTON LOCK
NOISE REDUCTION
OSD TIME : 5 ~ 30 SECOND
DEFAULT

RGB SETUP

H-POSITION
V-POSITION
COLCK
PHASE
AUTO CONFIG.

CYCLE SETUP

CYCLE TIME : 10 ~ 30 SECOND
CYCLE
VIDEO1
VIDEO2
S-VIDEO
RGB PC
DVI
HDMI
COMPONENT

TRIGGRT SETUP

TRIGGER MODE : OFF / FULL / DW1 / DW2
TRIGGER INPUT : VIDEO1 / VIDEO2 / S-VIDEO
TRIGGER DWELL : 10 ~ 60 SECOND

CONTROLL BUTTON

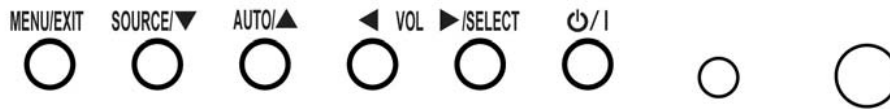

Menu/EXIT: Activates and exits the OSD.

SOURCE/▼: Select input source, and select the OSD menu.

AUTO/▲: Move the OSD menu and auto adjustment of RGB source.

▶/SELECT: Increase the level of volume and select the OSD menu.

◀ (VOL): Decrease the level of volume and move the previous menu.

⏻/I Turns the power ON or OFF. There will be a few seconds delay before the display appears.

The power LED(next to the power switch) lights with green when the power is turned ON.

The power is turned off by pressing the power switch again and the power LED goes Red.

LED LENS:

IR RECEIVE LENS:

INFORMATION TO THE USER

This equipment has been tested and found to comply with the limits for a Class B digital device, pursuant to part 15 of the FCC Rules. These limits are designed to provide reasonable protection against harmful interference in a residential installation. This equipment generates, uses and can radiate radio frequency energy and, if not installed and used in accordance with the instructions, may cause harmful interference to radio communications. However, there is no guarantee that interference will not occur in a particular installation. If this equipment does cause harmful interference to radio or television reception, which can be determined by turning the equipment off and on, the user is encouraged to try to correct the interference by one more of the following measures:

- Reorient or relocate the receiving antenna.
- Increase the separation between the equipment and receiver.
- Connect the equipment into an outlet on a circuit different from that to which the receiver is connected.
- Consult the dealer or an experienced radio / TV technician for help.

WARNING:

The manufacturer is not responsible for any Radio or TV interference caused by unauthorized modifications to this equipment. Such modifications could void the user's authority to operate the equipment."

TROUBLESHOOTING

* When the following troubles are occurred, follow the trouble shooting. Before contacting a service center.

Troubleshooting	Troubleshooting Tip
The screen doesn't show up	1. Make sure if the power supply is connected property
	2. Turn on the power.
	3. Select the input signal right for the connected port.
The screen is too light or to dark	Control the BRIGHTNESS
The screen size is not fit for the PC signal	Press the AUTO key among keys in the front. (It is used only in the PC signal)
The screen color shows strange in the PC signal	In the FUNCTION menu of OSD menu, perform the AUTO-ADJUST.

2Year Limited Warranty

All **Orion Images** products carry a limited warranty from ship date against defects in materials and workmanship. Orion Images is not liable for improper installation that results in damage to mounts, adapters, display equipment or personal injury.

Contact Orion Images

In the event of missing and/or damage equipment, or technical questions, the following information can help in the completion of the installation.

Address: 7300 Bolsa Avenue, Westminster, CA 92683

Tel: 714-766-6300 / Fax: 714-766-6310

Email: sales@orionimages.com

Website: <http://www.orionimages.com>