



---

INSTRUCTION BOOK FOR  
Parallax™ Thin

---



## Preparation

---

**Note:** It requires two people to install a Parallax Thin. To maintain optimal projected image geometry and screen alignment, a flat and straight wall free from obstructions and angular distortions should be used.

Choose a clean work area for assembly using padded material or other soft, clean materials. The work area should be larger than the overall screen size and directly in front of the location where the screen is to be installed.

## Tools Required For Assembly

---



Drill



Drill Bits

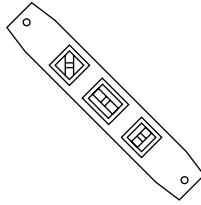

Level

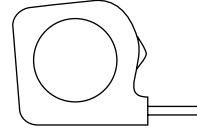

Measuring Tape

## Hardware Provided

---

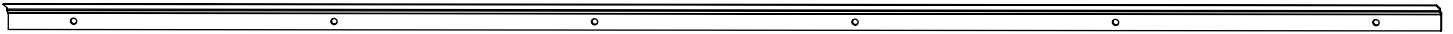

44" Wall Bracket  
(2) 92", 96" and 105½" Wide Screens



28" Wall Bracket  
(2) 80" and 87" Wide Screens

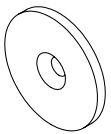

(1) Striker plate with countersunk hole for #10 screw

## Cleaning

---

Parallax screen surface can be cleaned as follows:

Using a white clean cloth (100% cotton preferred) that is dampened with clean water, gently wipe the area in a horizontal direction. Do not wipe in a vertical direction or with a circular motion. Using a dry 100% cotton cloth, wipe screen surface dry in horizontal direction after each cleaning. Windex Original spray cleaner can be used on tough to clean areas.

## Wall Mounting Instructions

**NOTE:** The screen is shipped with two wall brackets. Screens in widths of 88 $\frac{3}{4}$ " and below receive (2) 28" wall brackets. Screens above 88 $\frac{3}{4}$ " in width receive (2) 44" wall brackets. Use appropriate mounting hardware for the wall type and to accommodate for the screen's hanging weight (Figure 1).

1. Secure the two wall brackets to wall studs at the desired height. The outside edge of each wall bracket must be no greater than 5" away from the left and right edges of the frame. You will need at least 2" clearance above the drilled holes to hang the screen (Figure 1).
2. To install the striker plate, take your screens overall height (including frame) and subtract 1 $\frac{1}{4}$ ". Using that dimension, measure down from the top edge of the wall brackets and mark the wall for a screw hole (Figure 1).

**NOTE:** Make sure your mark corresponds with where you intend the center of your image to be once the screen is fully installed.

3. Secure the striker plate to the wall at the marked locations.

**NOTE:** Make sure the screw head is flush to the face of the striker plate so that the full pull force of the magnet is achieved.

4. With two people, one on either end of the screen, lift the screen onto the wall. Making sure the wall brackets are securely seated in the back of the screens frame.
5. Slowly lower the bottom of the screen, making sure the center of the screen is aligned with the striker plate on the wall.

**⚠ CAUTION: Pinch Hazard. While lowering the screen, be careful to keep your fingers clear of the magnet and striker plate.**

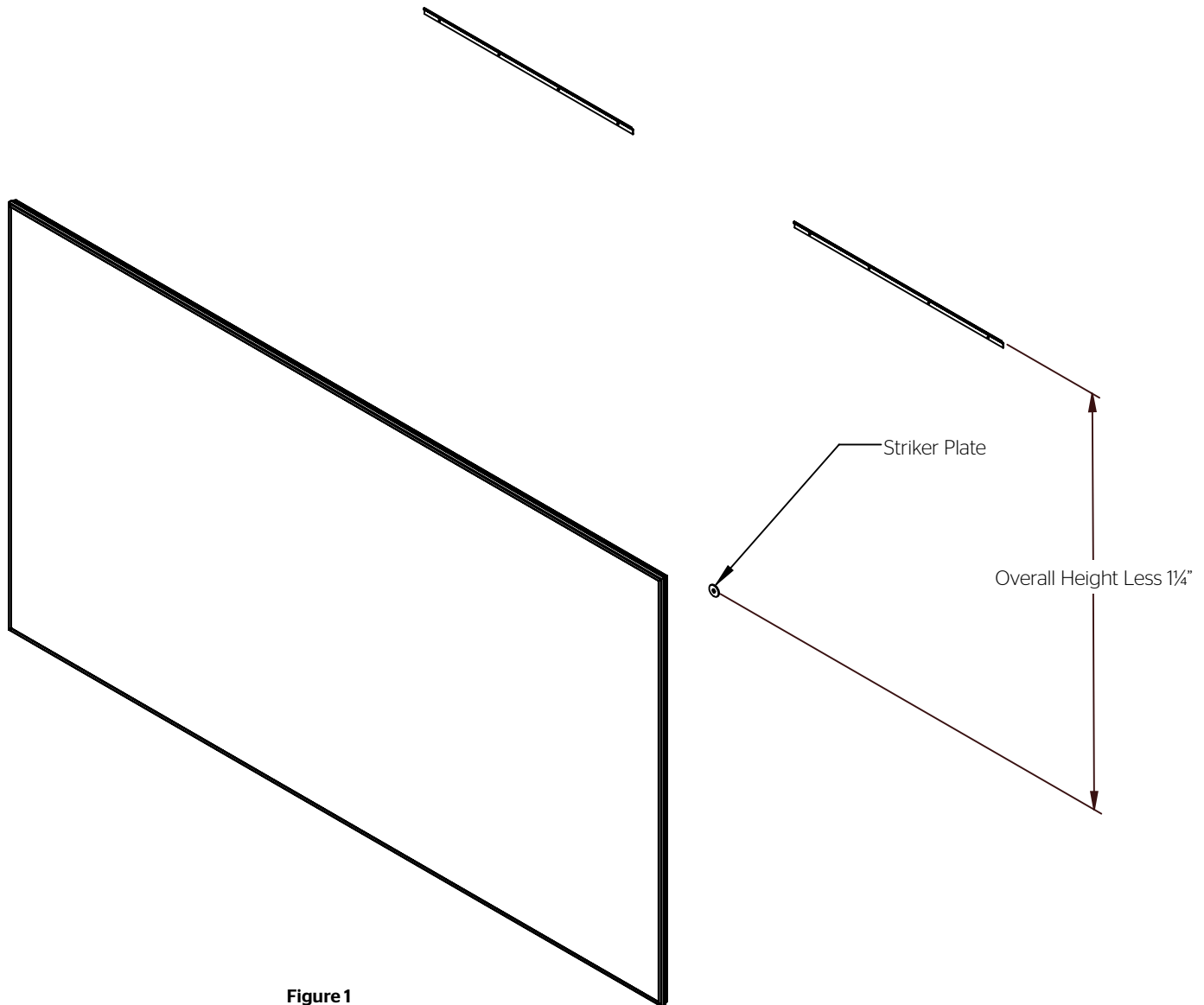

Figure 1

## LIMITED ONE YEAR WARRANTY ON DA-LITE PRESENTATION PRODUCTS

Milestone AV Technologies LLC warrants certain Da-Lite branded products to the original purchaser only, to be free from defects in materials and workmanship for a period of one (1) year from the date of purchase by the original purchaser; provided they are properly operated according to Da-Lite's instructions and are not damaged due to improper handling or treatment after shipment from the factory.

This warranty does not apply to equipment showing evidence of misuse, abuse or accidental damage, or which has been tampered with or repaired by a person other than authorized Da-Lite personnel.

Da-Lite's sole obligation under this warranty shall be to repair or to replace (at Da-Lite's option) the defective part of the merchandise. Returns for service should be made to your Da-Lite dealer. If it is necessary for the dealer to return the screen or part to Da-Lite, transportation expenses to and from Da-Lite are payable by the purchaser and Da-Lite is not responsible for damage in shipment. To protect yourself against damage or loss in transit, insure the product and prepay all transportation expenses.

**TO THE MAXIMUM EXTENT PERMITTED BY APPLICABLE LAW, THIS WARRANTY IS IN LIEU OF ALL OTHER WARRANTIES, EXPRESS OR IMPLIED, INCLUDING WARRANTIES AS TO FITNESS FOR USE AND MERCHANTABILITY.** Any implied warranties of fitness for use, or merchantability, that may be mandated by statute or rule of law are limited to the one (1) year warranty period. This warranty gives you specific legal rights, and you may also have other rights, which vary from state-to-state. **TO THE MAXIMUM EXTENT PERMITTED BY APPLICABLE LAW, NO LIABILITY IS ASSUMED FOR EXPENSES OR DAMAGES RESULTING FROM INTERRUPTION IN OPERATION OF EQUIPMENT, OR FOR INCIDENTAL, DIRECT, OR CONSEQUENTIAL DAMAGES OF ANY NATURE.**

In the event that there is a defect in materials or workmanship of a Da-Lite product, you may contact our Customer Care Specialists at 3100 North Detroit Street, Warsaw, IN 46582, (574) 267-8101, (800) 622-3737.

**IMPORTANT: THIS WARRANTY SHALL NOT BE VALID AND DA-LITE BRANDED PRODUCTS SHALL NOT BE BOUND BY THIS WARRANTY IF THE PRODUCT IS NOT OPERATED IN ACCORDANCE WITH THE DA-LITE WRITTEN INSTRUCTIONS.**

Keep your sales receipt to prove the date of purchase and your original ownership.



A Milestone AV Technologies Brand

3100 North Detroit Street  
Warsaw, Indiana 46582  
P: 574.267.8101 or 800.622.3737  
F: 574.267.7804 or 877.325.4832  
E: info@da-lite.com  
www.da-lite.com

DL-0632 01.16

© 2016 Milestone AV Technologies LLC. Printed in U.S.A.

29090