

Dear Valued Customer

(JUST WANTED YOU TO KNOW)

**WE REALLY
APPRECIATE
YOUR PURCHASE**

~thank you~

Features

- Only Support M.2 PCIe NVME SSD
- Support sizes 2230, 2242, 2260 and 2280
- Support USB 3.1 Gen2 10 Gbit/s
- Thermal Pad included, promote heat dissipation
- No driver installation required

Package contents

- USB Type-C to M.2 PCIe NVMe SSD Enclosure
- Thermal Pad (remove covers before use)
- USB Type C to A cable
- USB Type C to C cable
- Screw kit
- Quick Start Guide

System Requirements

1. Desktop PC with an available USB 3.1 port
2. Windows® 10 (32-/64-bit) / 8.x (32-/64-bit)
/ 7 (32-/64-bit)
3. Mac OS X® 10.14 to 10.10

Layout

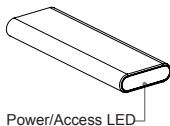
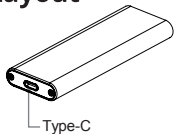

Install

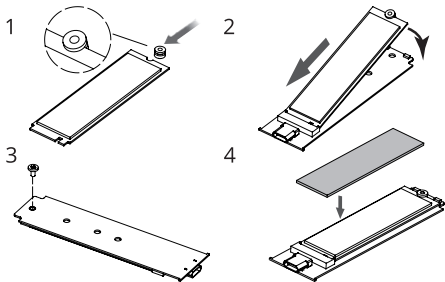

Support

lot number

For more info or tech support
<http://www.siig.com/support>



USB 3.1 Gen 2 Type-C to M.2 PCIe NVMe SSD Enclosure

Quick Start Guide

