

Installation Guide

Universal RJ45 Plug Lock, Locking Insert and Key

Models: N2LOCK-010-YW,
N2LPLUG-010-YW, N2LOCK-KEY-RD

Este manual esta disponible en español en la página
de Tripp Lite: www.tripplite.com/support

Ce manuel est disponible en français sur le site Web
de Tripp Lite : www.tripplite.com/support

Русскоязычная версия настоящего руководства
представлена на веб-сайте компании Tripp Lite
по адресу: www.tripplite.com/support

WARRANTY REGISTRATION

Register your product today and be automatically entered
to win an ISOBAR surge protector in our monthly drawing!

www.tripplite.com/warranty



1111 W. 35th Street, Chicago, IL 60609 USA
www.tripplite.com/support

Copyright © 2019 Tripp Lite. All rights reserved.

Installation



This product may not be suitable for some top opened (shown below) or special jack applications.

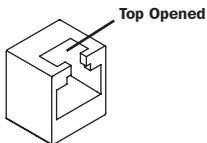

This product is designed to work with following RJ45 jack dimensions:

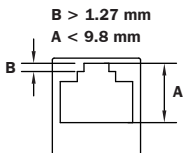

Installation

N2LOCK-010-YW Plug Lock Installation

- 1** Bend the latch back and forth to create a creasing line.

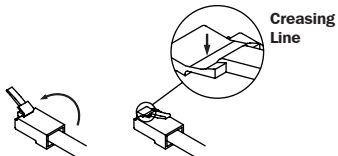

- 2** Align the cutter with the creasing line to cut off the latch.

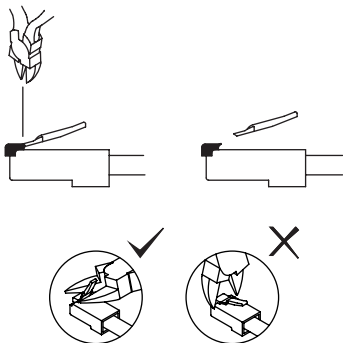

3

Installation

- 3 Affix the Plug Lock onto the RJ45 connector.

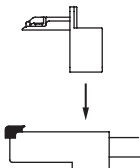

Note: Always check for proper fitting of the latch. Otherwise, it can cause damage to the RJ45 jack.

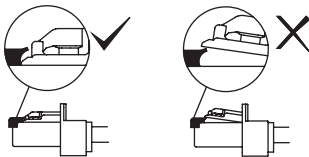

Installation

- 4 Plug the newly affixed RJ45 connector directly into the desired RJ45 jack.

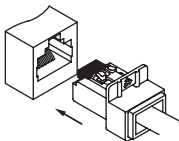

Note: A click sound will indicate the RJ45 connector is properly locked into place.

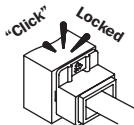

Installation

N2LPLUG-010-YW Plug Locking Insert Installation

- 1 Plug the Locking Insert directly into the RJ45 jack.

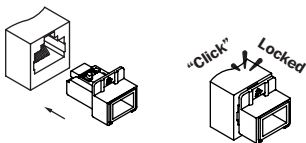

Note: A click sound will indicate the Locking Insert is properly locked into place.

Operation

N2LOCK-KEY-RD Plug Key Removal

Note: This key will release both the N2LOCK-010-YW Plug Lock and N2LPLUG-010-W Plug Locking Insert.

- 1** Insert the teeth of the key into the available groove located at the top of the locking plug.

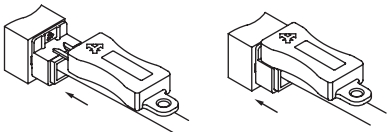

- 2** Pull out the plug and key together.

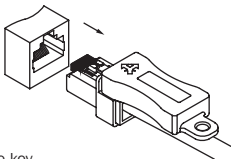

- 3** Release the key.

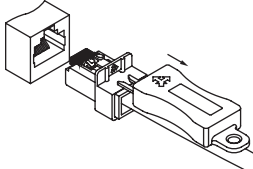



1111 W. 35th Street, Chicago, IL 60609 USA
www.tripplite.com/support