

# EVOLVE<sup>2</sup> 40



User manual

© 2020 GN Audio A/S. All rights reserved. Jabra® is a trademark of GN Audio A/S.

---

Made in China  
MODEL: HSC130

---

**Declaration of Conformity** can be found on  
[www.jabra.com/doc](http://www.jabra.com/doc)

1. Welcome.....	4
2. Jabra Evolve2 40 overview.....	5
2.1 Included accessories	
3. How to connect.....	6
3.1 Connect to computer	
3.2 Connect to mobile devices	
4. How to wear .....	8
4.1 Wearing styles	
4.2 Adjusting the headset	
5. What the LEDs mean .....	10
6. How to use .....	11
6.1 Calls & music	
6.2 Mute/unmute using the microphone boom-arm	
6.3 Answer call using the microphone boom-arm	
6.4 Sidetone	
6.5 Voice guidance	
6.6 Multiple call handling	
7. Software and firmware .....	17
7.1 Jabra Direct	
7.2 Update firmware	
8. Support .....	18
8.1 FAQ	
8.2 How to care for your headset	

# 1. Welcome

Thank you for using the Jabra Evolve2 40. We hope you will enjoy it!

## **Jabra Evolve2 40 features**

- 3-microphone call technology
- Designed for all-day comfort
- Built-in Busylight
- 40mm speaker for exceptional sound

## 2. Jabra Evolve2 40 overview

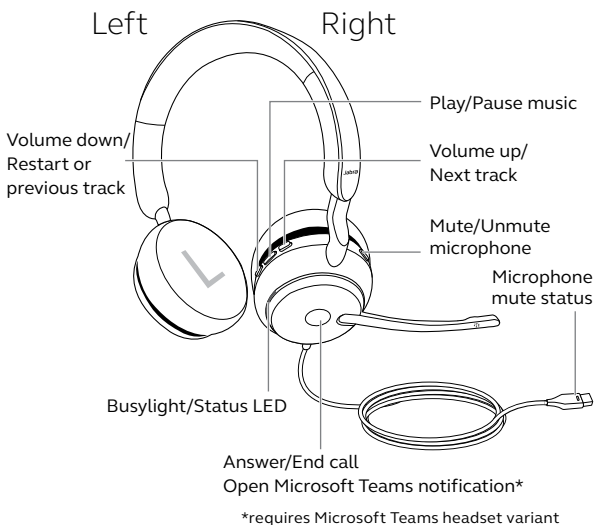

### 2.1 Included accessories

---

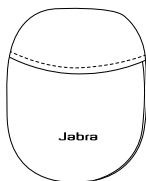

Carry pouch

# 3. How to connect

## 3.1 Connect to computer

---

Plug the Jabra Evolve2 40 into either a USB-A or USB-C port on your computer, depending on the USB variant of the headset.

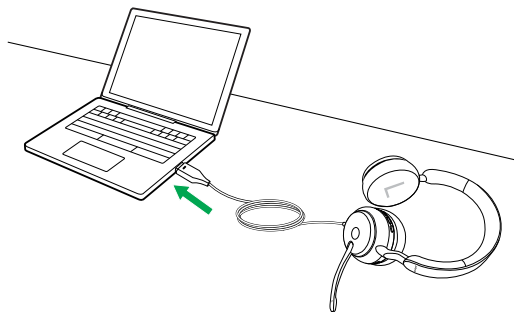

## 3.2 Connect to mobile devices

---

Plug the Jabra Evolve2 40 into a USB-C port on your mobile device. Not all USB-C devices or apps support an audio connection to the Jabra Evolve2 40.



# 4. How to wear

## 4.1 Wearing styles

---

### Mono variant

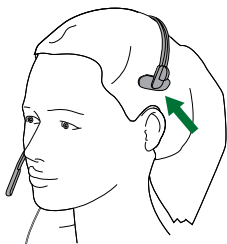

### Stereo variant





## 4.2 Adjusting the headset

---

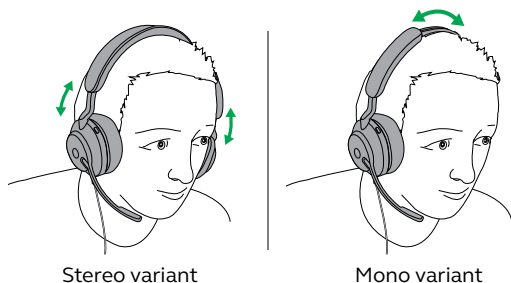

While wearing the headset, adjust the headband so that it fits your head comfortably.

When using the microphone, it should be positioned close to your mouth.

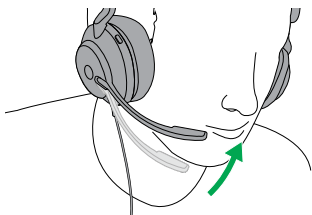

## 5. What the LEDs mean

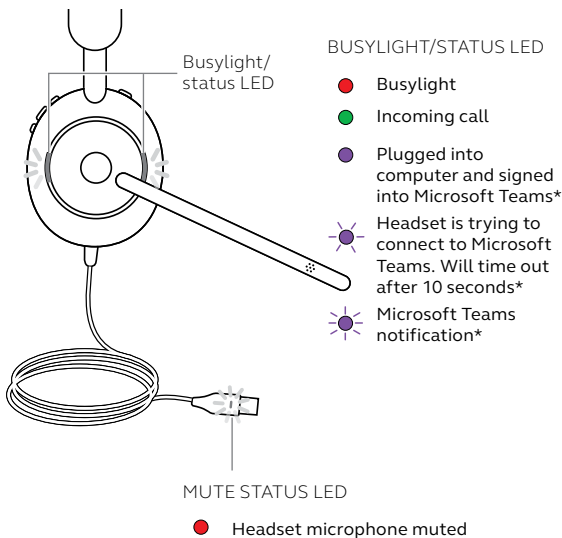

\*requires Microsoft Teams headset variant

When the headset is being worn, the LEDs will turn off to avoid distracting other people. The Busylight and mute status LEDs will not turn off.

## 6. How to use

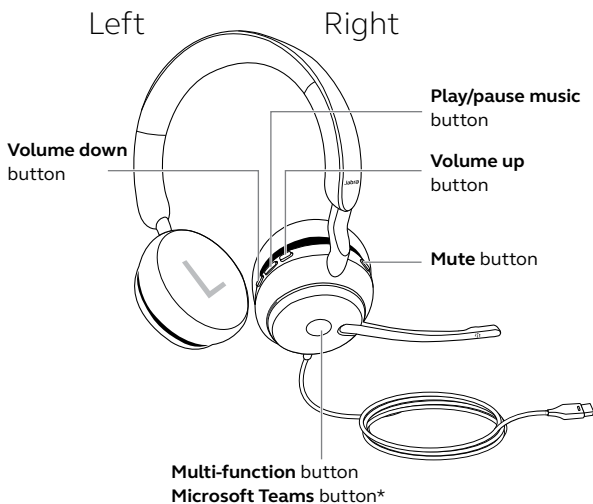

\*requires Microsoft Teams headset variant

## 6.1 Calls & music

---

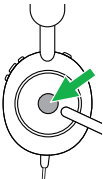
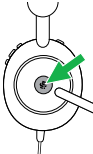
Right	Calls and music	
	Answer call	Press the <b>Multi-function</b> button  Alternatively, move the microphone boom-arm down to answer an incoming call
	End call	Press the <b>Multi-function</b> button
	Reject call	Double-press the <b>Multi-function</b> button
	Bring Microsoft Teams to foreground on computer	Press the <b>Microsoft Teams</b> button* (when signed into Microsoft Teams)
	Join active Microsoft Teams meeting	Press the <b>Microsoft Teams</b> button* (when signed into Microsoft Teams)
	View Microsoft Teams missed calls and voicemails	Press the <b>Microsoft Teams</b> button* (when signed into Microsoft Teams)

\*requires Microsoft Teams headset variant

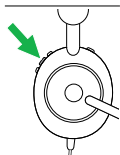

Play/pause music

Press the **Play/pause music** button

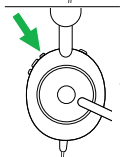

Raise volume

Press the **Volume up** button

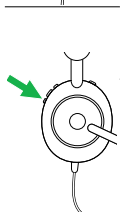

Next track

Press and hold (1 sec) the **Volume up** button

Lower volume

Press the **Volume down** button

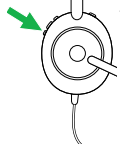

Restart track

Press and hold (1 sec) the **Volume down** button to restart the current track.

Press and hold twice to play the previous track.

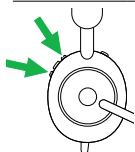

Busylight on/off

Press the **Volume up** and **Volume down** buttons at the same time

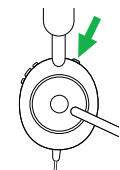

Mute/unmute microphone

Press the **Mute** button, when on a call.

Alternatively, move the microphone boom-arm up to mute, or down to unmute.

## 6.2 Mute/unmute using the microphone boom-arm

---

The headset microphone can be muted by moving the microphone boom-arm up, or unmuted by moving it down. This feature is on by default, and can be disabled using Jabra Direct.

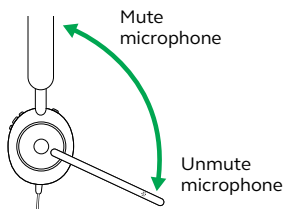

## 6.3 Answer call using the microphone boom-arm

---

An incoming call can be answered by moving the microphone boom-arm down, close to your mouth. This feature is on by default, and can be disabled using Jabra Direct.

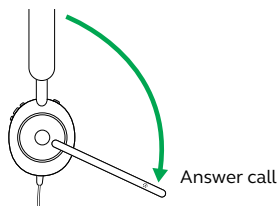

## 6.4 Sidetone

---

Sidetone enables you to better hear your own voice when you are on a call.

Sidetone settings can be configured using Jabra Direct.

## 6.5 Voice guidance

---

Voice guidance are announcements that will guide you through set up, or will give you headset status updates (e.g. mute status).

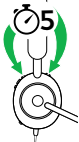
Right	Voice guidance
	<p>Turn Voice guidance on/off</p> <p>Press and hold (5 sec) the <b>Mute</b> button and the <b>Volume up</b> button until you hear an announcement</p>

Alternatively, use Jabra Direct to turn Voice guidance on or off.

## 6.6 Multiple call handling

---

The headset can accept and handle multiple calls at the same time.

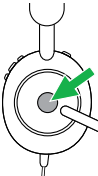
Right	Multiple call handling	
	End current call and answer incoming call	Press the <b>Multi-function</b> button
	Put current call on hold and answer incoming call	Hold (2 secs) the <b>Multi-function</b> button
	Switch between held call and active call	Hold (2 secs) the <b>Multi-function</b> button
	Activate Cortana	Hold (2 secs) the <b>Microsoft Teams</b> button*
	Reject incoming call, when on a call	Double-press the <b>Multi-function</b> button

\*requires Microsoft Teams headset variant



# 7. Software and firmware

## 7.1 Jabra Direct

---

Jabra Direct is computer software designed to support, manage and enable optimal functionality for Jabra devices.

Download the latest free version from [jabra.com/direct](https://jabra.com/direct)

## 7.2 Update firmware

---

Firmware updates improve performance or add new functionality to Jabra devices.

1. Connect the Jabra Evolve2 40 to a computer.
2. Use Jabra Direct to check for the latest firmware updates.

# 8. Support

## 8.1 FAQ

---

View the FAQs on [Jabra.com/help/evolve2-40](https://www.jabra.com/help/evolve2-40).

## 8.2 How to care for your headset

---

- Always store the headset in the supplied pouch.
- Avoid storage at extreme temperatures (above 40°C/113°F or below -40°C/-40°F).
- Do not expose the headset to rain or other liquids.

[jabra.com/evolve2-40](http://jabra.com/evolve2-40)