

Canon

BINOCULARS

8×20 IS

10×20 IS



IMAGE STABILIZER

ENG

Instructions

Thank you for purchasing a Canon product.

The Canon 8x20 IS (8x) and 10x20 IS (10x) prism binoculars are equipped with a lens-shift type Image Stabilizer.

Before using the binoculars, read this instruction booklet to familiarize yourself with the proper operation.

Also, please keep this instruction booklet in a safe place so that you can refer to it at anytime.

- “IS” stands for Image Stabilizer.

Symbols



Warning to prevent malfunction or damage to the binoculars.



Supplementary hints for using the binoculars.

Accessories

The binoculars come with the following accessories:

Case	1
Strap	1
Eyepiece lens caps.....	2
CR123A Lithium battery	1

Contents

Precautions for Use	ENG-2 - 4
Nomenclature	ENG-5
Using the Lens Caps	ENG-6
Installing the Strap.....	ENG-6
Loading the Batteries.....	ENG-7
Before You Start	ENG-9
Using the Image Stabilizer.....	ENG-10
Using the Case	ENG-11
Troubleshooting	ENG-12
Major Specifications	ENG-13

Precautions for Use (Please be sure to read before use)

- Please be sure to read this section carefully beforehand in order to use your binoculars correctly and safely.
- The following precautions are designed so that you will use your binoculars safely. Please be sure to read and follow them in order to prevent injury to you or others as well as damage to them.

Warning (regarding the binoculars)

Details pertaining to risks that may result in death or serious injury.



- **Never look at the sun with the binoculars. Doing so can cause loss of vision.**

- Do not place the binoculars under direct sunlight. Otherwise, the lens may concentrate the sun's rays and cause a fire.
- Keep the binoculars and accessories out of reach of small children.
- Keep the plastic bags used for packaging out of reach of small children since suffocation may occur if a bag is placed over their head.
- If the strap is mistakenly wrapped around the neck, suffocation may result.

Warning (regarding the batteries)

Details pertaining to risks that may result in death or serious injury.

- Store the batteries used with this product out of the reach of infants. Also, avoid replacing the batteries where the procedure can be observed by infants.
Swallowing the batteries will result in a chemical reaction occurring within the body, and is extremely dangerous. Seek the advice of a doctor immediately in the event of the batteries being swallowed.
- Please follow the precautions below when using batteries. Not doing so may result in overheating, generation of smoke, ignitions, battery leakage, and explosions which may lead to fire or personal injury.
 1. Be sure not to use batteries with a nominal voltage rating of 3.0V or higher or batteries which have no nominal voltage information.
 2. Make sure that the battery polarity is correct.
 3. Be sure not to use any battery that is leaking.
 4. Remove the batteries if anything unusual happens, such as smoke or unusual odors being emitted.
 5. Do not attempt to disassemble batteries, charge the batteries (except for rechargeable batteries), leave batteries in a hot place, short circuit the contacts, or throw them into a fire.

 **Caution (regarding the binoculars)**

Details pertaining to risks that may result in injury or damage to other objects.

- Do not place the binoculars on an unstable surface. Doing so may cause the binoculars to fall and could result in a personal injury.
- Do not use the binoculars while walking. Doing so may cause you to collide into objects or fall down and could result in a personal injury.
- Do not swing the binoculars around by the strap. Doing so may cause the surrounding people to be hit by the binoculars and could result in a personal injury or damage.
- Fingers may be pinched when adjusting the width of the binoculars. Be aware of this when the binoculars are being used by small children.
- If damaged, do not touch the damaged portion or inside the product.
- Do not wet, or allow liquids or foreign objects to enter.
- Do not store the product in very hot or cold places. The product itself will heat or cool, possibly causing burns or other injury when touched.
- When used for a prolonged period or when used repeatedly, the rubber eyecups may irritate the skin around the eyes. If you suspect that this may have occurred, please see a physician.

 **Caution (regarding the batteries)**

Details pertaining to risks that may result in injury or damage to other objects.

- Please remove the batteries when not using the binoculars. If the batteries are left inside, leakage may lead to malfunction, staining, or fire.
- In the event that liquid from the inside of the batteries leaks out and contacts your skin, be sure to wash the liquid off thoroughly. Also, do not rub your eyes or mouth using any hand that made contact with liquid from the batteries. If eyes or mouth are exposed to the liquid, thoroughly rinse in clean, cold water and seek medical attention immediately.
- When removing or disposing of batteries, insulate the contacts by covering them with tape, as contact with other metals may cause fire or rupturing.

Handling Precautions

- Obey any instructions that prohibit the use of this product in certain places.
- Binoculars are precision instruments. Do not use force on them, drop them, or subject them to severe shock or vibration. Also, do not disassemble or alter them.
- Do not store the binoculars in a car or similar location under direct sunlight. Doing so will cause the binoculars to reach a temperature higher than expected which may cause damage to occur.
- Do not use or store them in a humid, smoky or dusty environment. Storing the binoculars in a humid location may cause fungus to form on the lenses or cause the lenses to become cloudy. If the binoculars are not to be used for an extended period, clean the lenses and body thoroughly and store in a well-ventilated dry place.
- The binoculars are not waterproof. Avoid exposing the binoculars to rain or water spray.
If the binoculars come into contact with water, dry them with a dry, clean cloth. If dirt, dust or salt adheres to them, wipe them well with a clean, well-wrung wet cloth.
If water gets onto or into the binoculars, or you think dirt, dust, salt, etc. may have gotten in, promptly take the binoculars to a service center.
- Do not use any organic solvent, such as alcohol, thinner, or benzene when wiping the lenses or body.
If the lens is dirty, first use a blower brush to remove dust, etc., from the lens surface. Then use a soft, dry cloth and wipe the lens gently without scratching it.
- If the binoculars are taken from a cold environment to a warm one, condensation may develop on the surface and internal parts due to the sudden change in temperature. To prevent condensation, first put the binoculars into an airtight plastic bag before taking it to a warm environment. Let it gradually adjust to the warmer temperature, then take out the binoculars. Do the same when taking the binoculars from a warm environment to a cold one.

Nomenclature

(The 10x20 IS shown in the illustrations.)

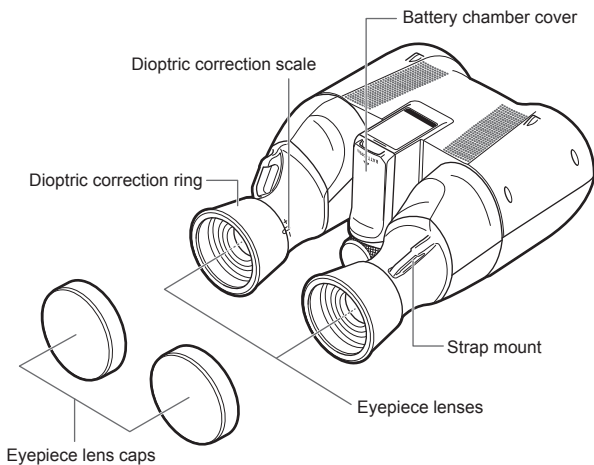
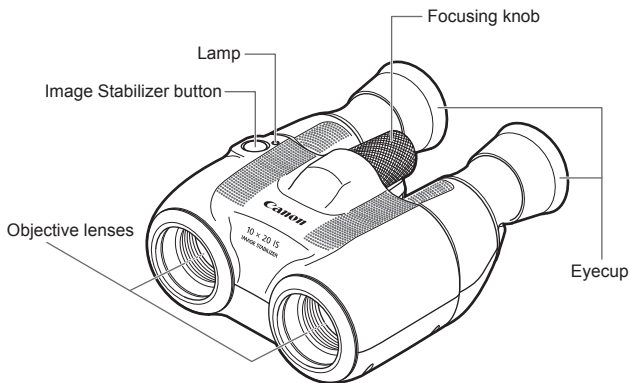

Using the Lens Caps

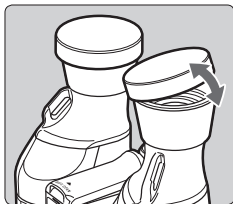

Detaching Eyepiece Lens Caps

- Detach the eyepiece lens caps from the eyecups when using the binoculars.

Attaching Eyepiece Lens Caps

- Attach the eyepiece lens caps to the eyecups after using the binoculars.

Installing the Strap

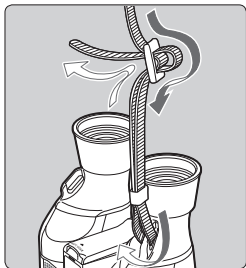

1 Fasten the strap.

- Place one end of the strap through the strap mount and then through the clasp, which is attached to the strap, from underneath.

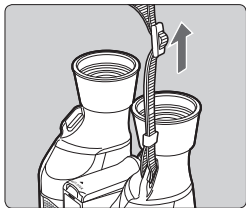

2 Check the clasp.

- Make sure that the strap does not loosen at the clasp when you pull it.



- When using the binoculars, check the condition of the strap (make sure that the strap is securely installed, that it is not worn (damaged), etc.).

Loading the Batteries

The binoculars are equipped with the Image Stabilizer that uses one CR123A lithium battery.



- Be sure not to use batteries with a nominal voltage rating of 3.0V or higher or batteries which have no nominal voltage.

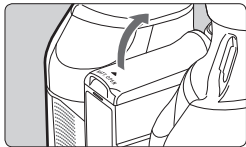

1 Open the cover.

- Open the battery chamber cover.

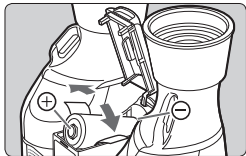

2 Insert the battery.

- Release the surface fasteners and open them out to the left and right.
- Load the battery in the correct [+] [-] orientation as indicated at the bottom of the battery chamber.
- When loading the battery, insert the [-] pole against the spring electrode inside the battery chamber, and then push it in as far as it will go.

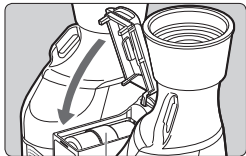

Surface fasteners

3 Fix the battery firmly in place with the surface fasteners.

- Wrap the surface fastener shown on the left in the illustration around the battery, and then wrap the right-hand surface fastener around the battery from above to fix it firmly in place. Check to make sure that the surface fasteners are not loose.
- Once the battery is in place, firmly close the battery chamber cover.

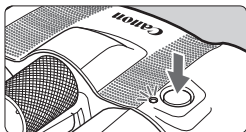

4 Check that the lamp lights.

- Press the Image Stabilizer button and check that the lamp lights. (Please continue to hold the button for more than one second.)



- When handling batteries, please carefully read “⚠ Warning (regarding the batteries)” and “⚠ Caution (regarding the batteries)” which are found on page 2-3 of this manual.
- When loading the battery, make sure that the [+] pole electrode is not inserted first. Failure to observe this may result in the [-] pole spring electrode being bent or otherwise damaged.
- When fixing the battery in place with the surface fasteners, check to make sure that the surface fasteners are not loose and show no wearing (damage).
- Be careful not to let moisture onto the inner side of the battery chamber cover or into the chamber. If there is moisture, make sure to remove it and adequately dry it off before changing batteries.
- Stop the Image Stabilizer before removing the batteries.

Battery Life (Continuous Use) (Based on Canon's testing conditions)

	23°C / 73°F	-10°C / 14°F
CR123A Lithium battery*	Approx. 12 hours	Approx. 8 hours

* Battery usage times can vary greatly depending on the brand.

Before You Start

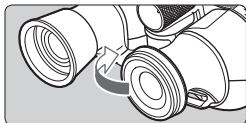

1 Adjust the eyecup position.

- When using the binoculars while wearing eyeglasses, turn the eyecups to adjust the height for easy viewing.

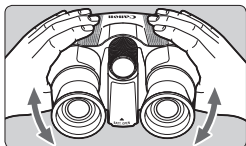

2 Adjust the width of the binoculars.

- Adjusting the width of the binoculars allows for sufficient performance and minimizes eye fatigue during viewing.
- Look through the binoculars and adjust the angle of the eyepieces until the left and right images converge.

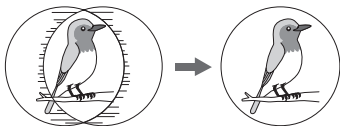

- When adjusting the width of the binoculars to suit the width between your eyes, look at a distant object.

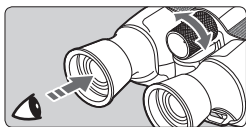

3 Adjust the diopter.

- Compensates for the difference in visual acuity between your left and right eyes.
- First look through the left eyepiece only and adjust the focusing knob until the object looks sharp.
- Then look through the right eyepiece only and look at the same object while turning the dioptic correction ring until the object looks sharp.

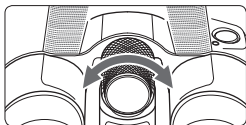
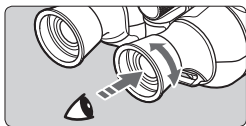

4 Adjust the focus.

- Look at a different object with both eyes through the binoculars and turn the focusing knob until the object looks sharp.

Using the Image Stabilizer

When you look through the binoculars, the image may be shaking and difficult to see since your hands are holding the binoculars. In such a case, the Image Stabilizer can help steady the image.

The Image Stabilizer can be operated using the following methods.

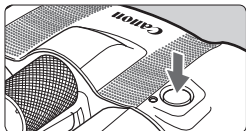

Five-minute operation and stopping operation

- Press the Image Stabilizer button and quickly let it go, and the Image Stabilizer will operate continuously for five minutes.
- To stop the Image Stabilizer, press and release the Image Stabilizer button again.

Starting and stopping Image Stabilizer operation while holding down the button

- The Image Stabilizer will operate while holding down the Image Stabilizer button.
- The Image Stabilizer will stop once you let go of the button.



- When the Image Stabilizer button is operating, the lamp turns on.
- If the lamp does not turn on, replace the batteries with new ones.
- The Image Stabilizer may not be able to compensate when the user's body is being deeply shaken, subjected to vibration, or when the user's hands are shaking too much.
- The Image Stabilizer will stop once the batteries run out.
- Even without batteries loaded, the binoculars can still be used as is.

Using the Case

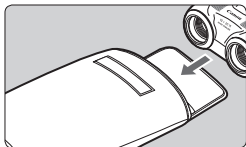

- 1 Place the binoculars in the case.**
- Place the binoculars in the case while allowing the strap to extend outside the case.

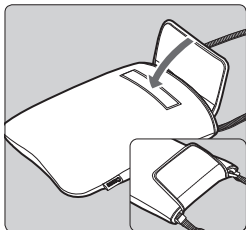

- 2 Close the case flap.**
- After the strap has been extended, close the case flap.



- Check to see that the lamp is off before placing the binoculars in the case.

Troubleshooting

If there is a problem with the binoculars, first refer to the table below to see if you can resolve it. If the problem cannot be resolved, contact your dealer or nearest Canon Service Center.

Problem	Probable Cause	Corrective Measures
The image is not clear.	The lens is dirty.	Use a blower brush to remove dust, etc., from the lens surface. Then use a soft, dry cloth to wipe the lens gently.
	The diopter has not been properly set.	Adjust the diopter. (See step 3 on page 9)
	The width of the binoculars does not suit the width between your eyes.	Adjust the width of the binoculars. (See step 2 on page 9)
	The binoculars are not properly focused.	Focus the binoculars. (See step 4 on page 9)
The Image Stabilizer does not operate.	There are no batteries loaded.	Load batteries having enough power. (See page 7 "Loading the Batteries")
	When the Image Stabilizer button is pressed, the lamp does not light.	If the lamp does not light, it means the batteries are exhausted. Replace the batteries with new ones. (See page 7 "Loading the Batteries")

Major Specifications

	8x20 IS	10x20 IS
Type	Prism binoculars	
Magnification	8x	10x
Objective lenses effective diameter	20 mm	
Real field of view	6.6°	5.3°
Apparent field of view*	49.5°	
Field of view at 1000 m / yds	115 m / 377 ft.	93 m / 305 ft.
Exit pupil diameter	2.5 mm	2.0 mm
Eye relief	13.5 mm	
Focusing distance range	Approx. 2 m (6.6 ft.) - infinity	
Interpupillary adjustment range	56 - 72 mm (2.2 - 2.8 in.)	
Image Stabilizer system	Optical correction with lens-shift	
Correction angle	±0.9°	
Battery check	Lamp (LED) turns on	
Power	1 CR123A Lithium battery	
Operating environment	Temperature: -10°C to 40°C / 14°F to 104°F Humidity: 90%	
Dimensions (W x L x H)	Approx. 118 x 142 x 69 mm / 4.6 x 5.6 x 2.7 in.	
Weight (Excluding batteries)	Approx. 420 g / 14.8 oz.	Approx. 430 g / 15.1 oz.

* Calculated based on ISO 14132-1:2002

This device complies with Part 15 of the FCC Rules. Operation is subject to the following two conditions: (1) This device may not cause harmful interference, and (2) this device must accept any interference received, including interference that may cause undesired operation.

Do not make any changes or modifications to the equipment unless otherwise specified in the instructions. If such changes or modifications should be made, you could be required to stop operation of the equipment.

This equipment has been tested and found to comply with the limits for a Class B digital device, pursuant to Part 15 of the FCC Rules. These limits are designed to provide reasonable protection against harmful interference in a residential installation.

This equipment generates, uses and can radiate radio frequency energy and, if not installed and used in accordance with the instructions, may cause harmful interference to radio communications. However, there is no guarantee that interference will not occur in a particular installation. If this equipment does cause harmful interference to radio or television reception, which can be determined by turning the equipment off and on, the user is encouraged to try to correct the interference by one or more of the following measures:

- Reorient or relocate the receiving antenna.
- Increase the separation between the equipment and receiver.
- Connect the equipment into an outlet on a circuit different from that to which the receiver is connected.
- Consult the dealer or an experienced radio/ TV technician for help.

CANON U.S.A. Inc.

One Canon Park, Melville, NY 11747, U.S.A.

Tel No. 1-800-OK-CANON (1-800-652-2666)

CAN ICES-3 (B) / NMB-3 (B)

Only for European Union and EEA (Norway, Iceland and Liechtenstein)



These symbols indicate that this product is not to be disposed of with your household waste, according to the WEEE Directive (2012/19/EU), the Battery Directive (2006/66/EC) and/or national legislation implementing those Directives.

If a chemical symbol is printed beneath the symbol shown above, in accordance with the Battery Directive, this indicates that a heavy metal (Hg = Mercury, Cd = Cadmium, Pb = Lead) is present in this battery or accumulator at a concentration above an applicable threshold specified in the Battery Directive.

This product should be handed over to a designated collection point, e.g., on an authorized one-for-one basis when you buy a new similar product or to an authorized collection site for recycling waste electrical and electronic equipment (EEE) and batteries and accumulators. Improper handling of this type of waste could have a possible impact on the environment and human health due to potentially hazardous substances that are generally associated with EEE. Your cooperation in the correct disposal of this product will contribute to the effective usage of natural resources.

For more information about the recycling of this product, please contact your local city office, waste authority, approved scheme or your household waste disposal service or visit www.canon-europe.com/weee, or www.canon-europe.com/battery.

Canon