



RAZER RAPTOR 27

MASTER GUIDE

Updated with the capability and clarity you need to game at your best, the new **Razer Raptor** is now faster than ever with up to 165Hz refresh rate and new THX® Certified visual clarity. The perfect combination of style and performance, the latest Raptor still sports an IPS panel with QHD (2560 x 1440px) resolution and is built upon the previous sleek cable management stand, giving a streamlined visual experience both on screen and on your desk.

CONTENTS

1. WHAT'S INSIDE	3
2. WHAT'S NEEDED	5
3. LET'S GET YOU COVERED	6
4. TECHNICAL SPECIFICATIONS.....	7
5. GETTING STARTED	8
6. CONFIGURING YOUR RAZER DEVICE	11
7. SAFETY AND MAINTENANCE	20
8. LEGALESE.....	21

1. WHAT'S INSIDE

- Razer Raptor 27 Gaming Monitor
(Model No: Rz39-0350)

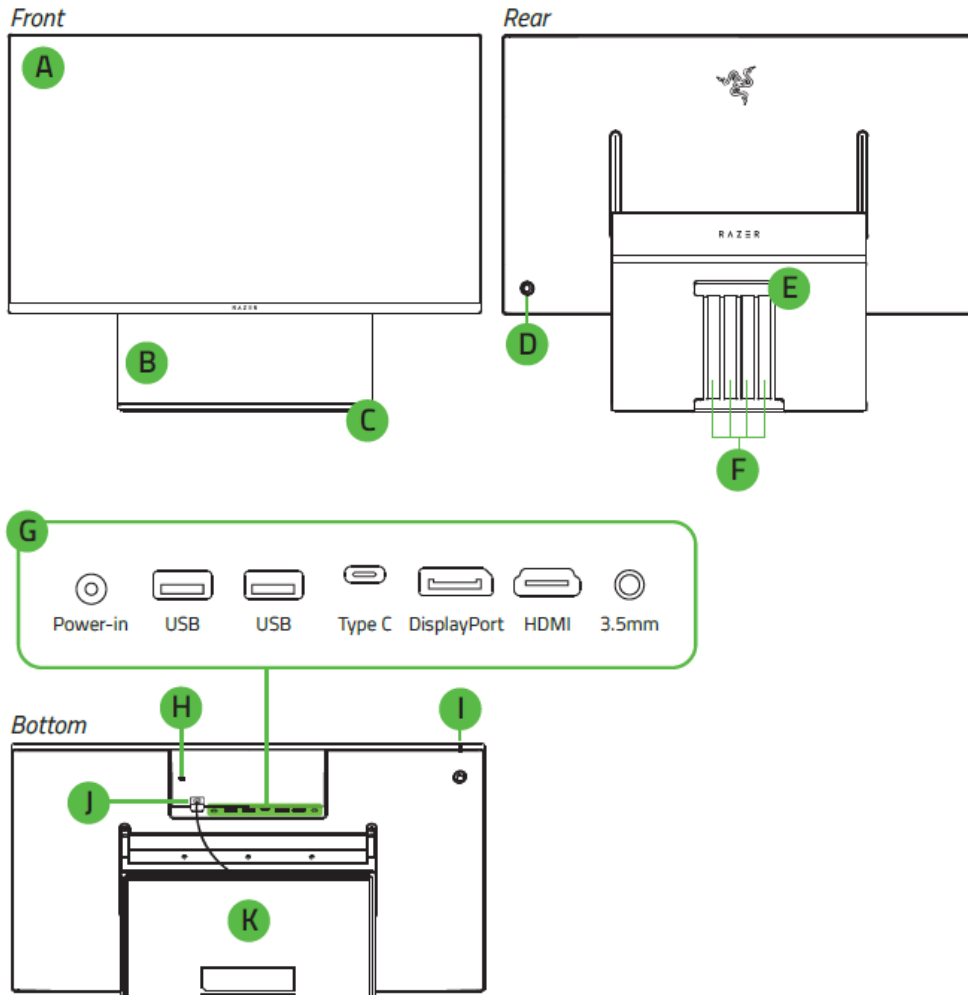

- A. 27" IPS WQHD display
- B. Height adjustable stand
- C. Razer Chroma underglow lighting
- D. 5-way menu joystick
- E. Cable routing hole
- F. Cable channel slats
- G. Input/output ports
 - Power port
 - 2x USB passthrough ports
 - Type C port
 - DisplayPort 1.4
 - HDMI 2.0 port
 - 3.5mm combo jack
- H. Kensington lock
- I. Power Indicator
- J. Razer Chroma USB connector
- K. Non-slip rubber base

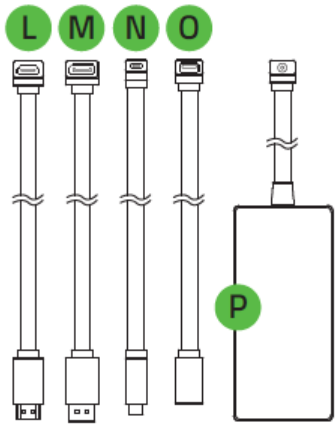

- L. HDMI cable
- M. DisplayPort cable
- N. Type C cable
- O. USB extension cable
- P. Power adapter + regional power cord

- Important Product Information Guide

2. WHAT'S NEEDED

PRODUCT REQUIREMENTS

- Systems with any of the following display outputs:
 - HDMI 2.0
 - DisplayPort 1.4
 - Type C

RAZER SYNAPSE REQUIREMENTS

- PC with a free Type C port
- Windows®7 64-bit (or higher)
- Internet connection for software installation

3. LET'S GET YOU COVERED

You've got a great device in your hands complete with a 1-year limited warranty coverage. Now, maximize its potential and score exclusive Razer benefits by registering at razerid.razer.com

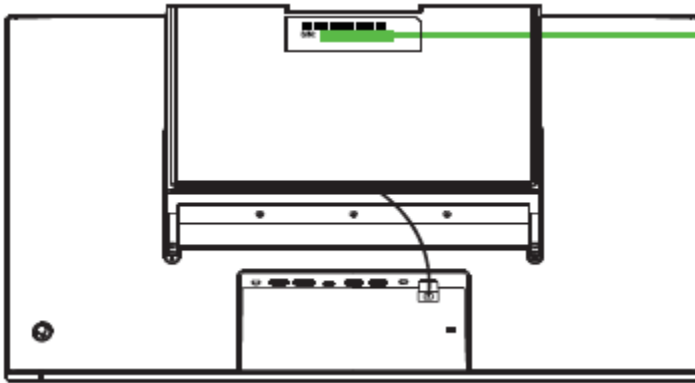

Your product's serial number can be found here.

4. TECHNICAL SPECIFICATIONS

FEATURES

Product Code	RZ39-02760100-R3U1
Display	27" QHD (2560 x 1440px) resolution Non-Glare IPS Display with up to 178° wide viewing angles
Refresh Rate	165Hz Refresh Rate
Response Time	1ms with Ultra Low Motion Blur
Adaptive Sync	NVIDIA® G-Sync Compatible AMD FreeSync™ Premium Supported
Graphics	HDR400, 8-Bit + FRC dimming processor Factory Calibrated 95% DCI-P3 wide color gamut
Contrast Ratio	1000:1
Brightness	420 nits / 380 nits Typical
VESA Compatible	VESA Mount Adapter Sold Separately
Input & Output	HDMI 2.0b DisplayPort 1.4 USB-C (Support for DP 1.4 in Alt Mode) 2x USB-A 3.2 Gen1 Power Plug
Cable Management	Built-in CNC cable management system
Bezel Size	2.3mm Ultra-Thin Bezels
Rotation	90° Backwards Tilt for Easy Port Access
Height Adjustable	100mm Travel (Up/Down)
Included Cables	1x HDMI Cable 1x DisplayPort Cable 1x USB-C Cable 1x USB-A Extension Cable

5. GETTING STARTED

SETTING UP YOUR RAZER RAPTOR 27

Before you can enjoy your gaming monitor, you'll first need to set it up to your battle station by following these few easy steps:

1. Adjust the screen to its maximum height, then tilt it 90-degrees back.

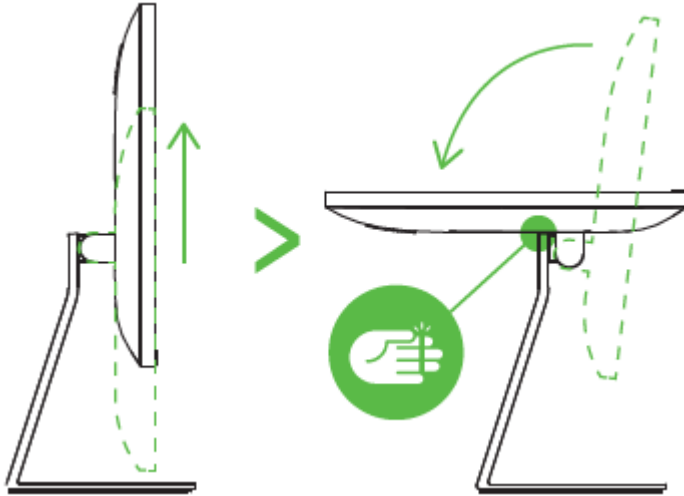

i *Caution: The monitor has an auto raise mechanism that prevents the screen from tilting at extreme angles. Do not force the screen to tilt 90-degrees when it is at the lowest point, doing so may cause serious damage to the external parts of the monitor; and void its warranty. Do not put your hand near the hinge cover or railings to avoid injury.*

2. Remove the slats from the stand.

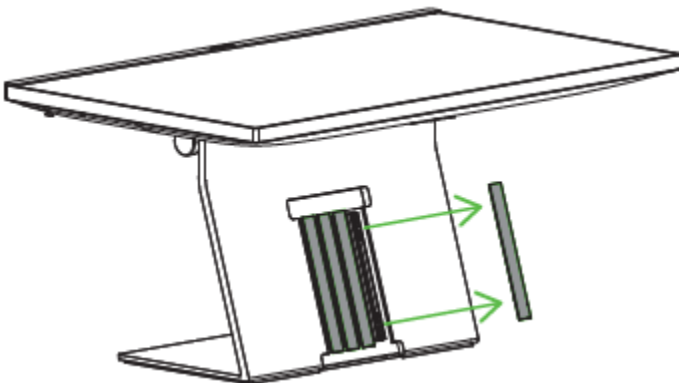

3. Insert the cables through the hole and then plug them to their respective ports.

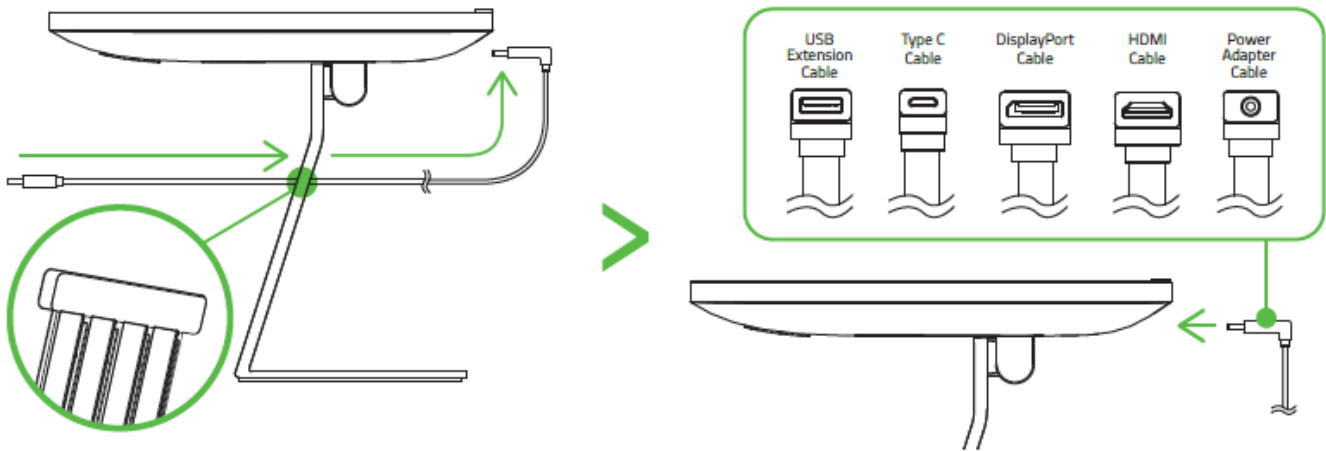

i It is recommended to fasten your monitor to a wall using a standard Kensington cable lock (Not included) during this step. Installation must be done by a qualified technician. Contact your dealer for more information.

Bottom view

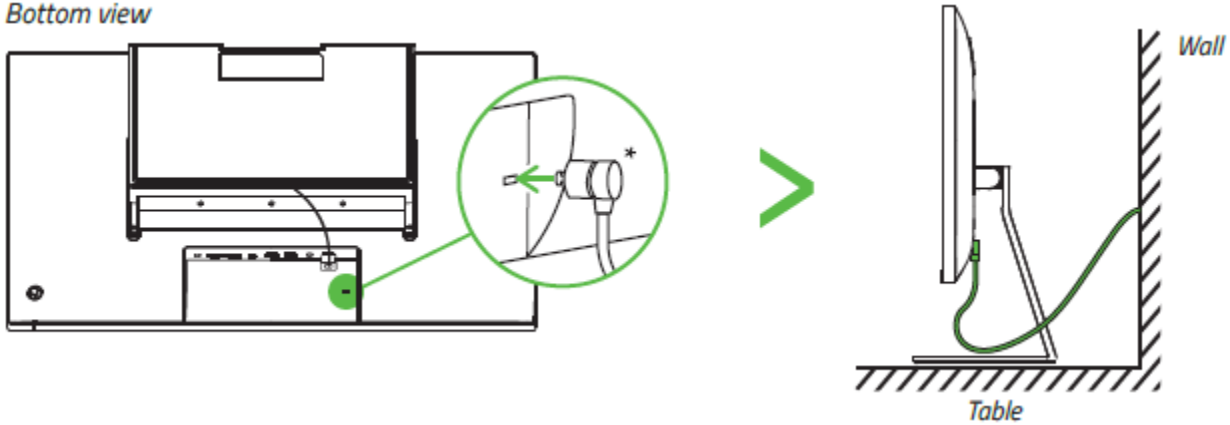

4. Place each flat cable into the nearest unoccupied channel and then reattach the slats.

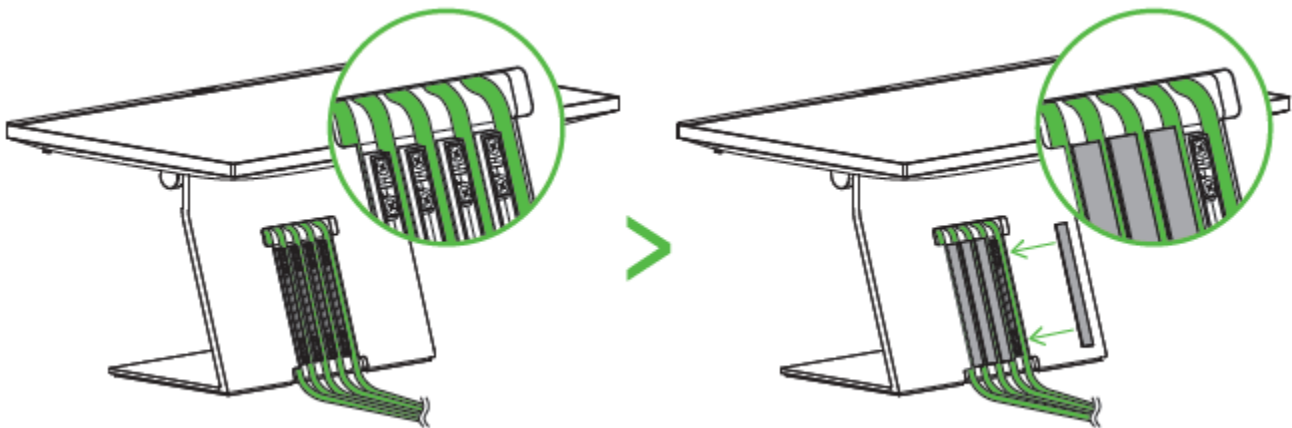

5. Tilt the screen upright while bending the cables inwards for a cleaner aesthetic.

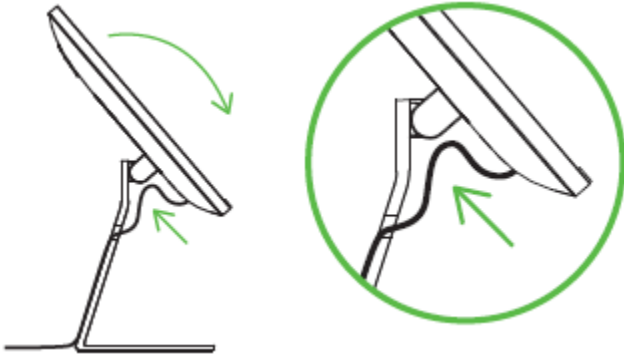

6. Plug the adapter to an outlet using the provided power cables, and connect the HDMI, DisplayPort, or Type C to a video source.

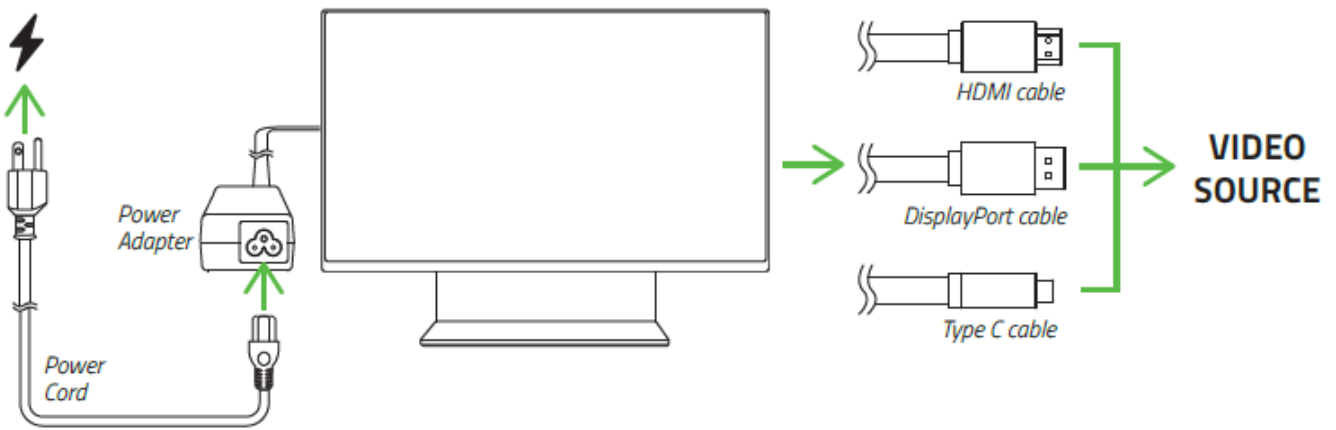

i To customize the Razer Chroma underglow lighting, connect the Type C cable to your PC.

7. Adjust the screen to your desired height and tilt.

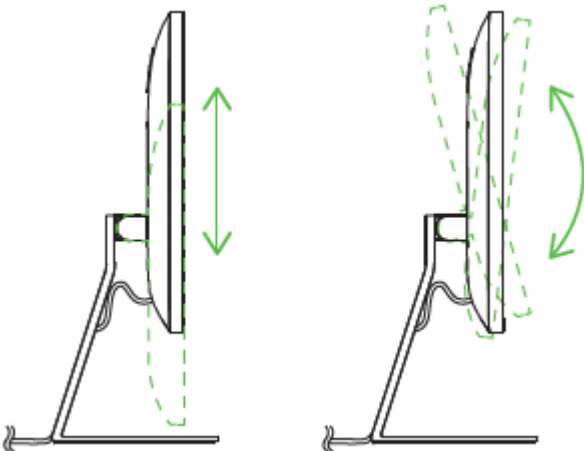

6. CONFIGURING YOUR RAZER DEVICE

Disclaimer: The features listed here require you to log into Razer Synapse 3. These features are also subject to change based on the current software version and your Operating System. Refers to function applicability. Certain products may or may not have the indicated function.

SYNAPSE TAB

The Synapse tab is your default tab when you first launch Razer Synapse 3. This tab allows you to navigate the Dashboard subtab.

Dashboard

The Dashboard subtab is an overview of your Razer Synapse 3 where you can access all your Razer devices, modules, and online services.

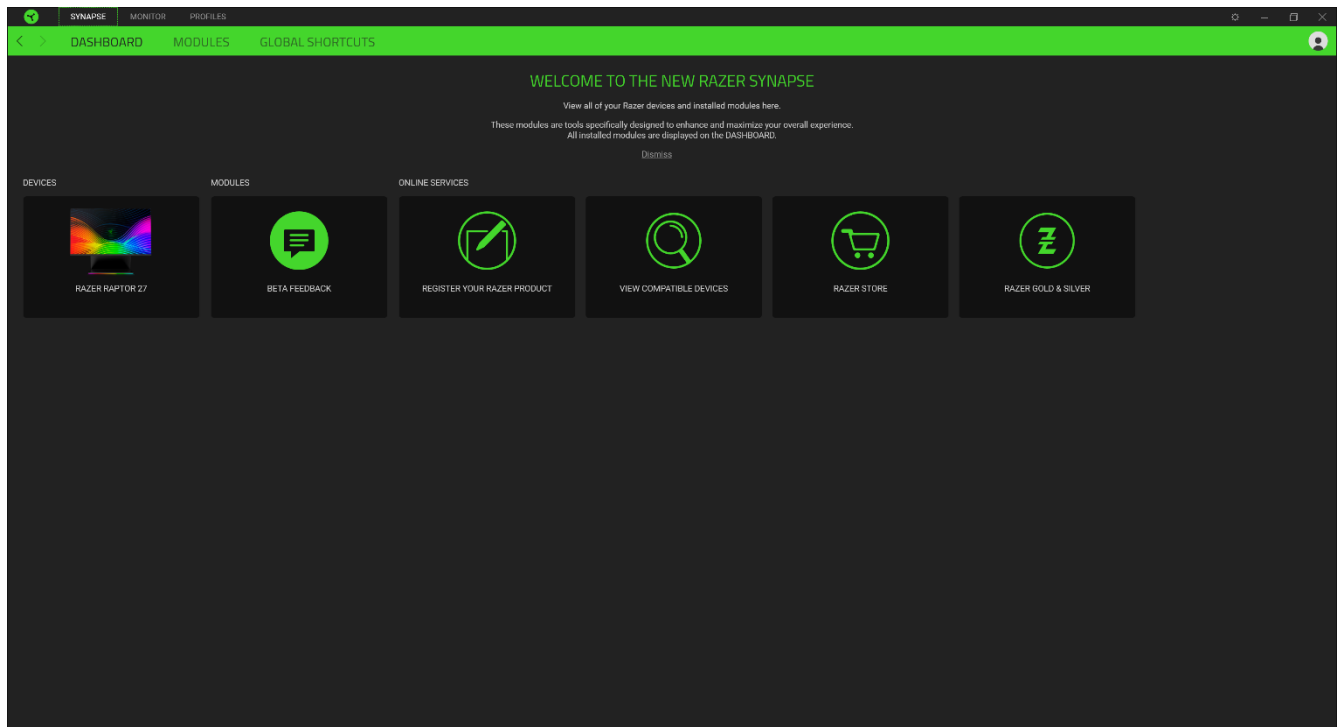

MONITOR TAB

The Monitor tab is the main tab for your Razer device. From here, you can change your device's settings such as color, lighting, and display. Changes made under this tab are automatically saved to your system and cloud storage.

Gaming

The Gaming subtab is for modifying your monitor's display and performance settings.

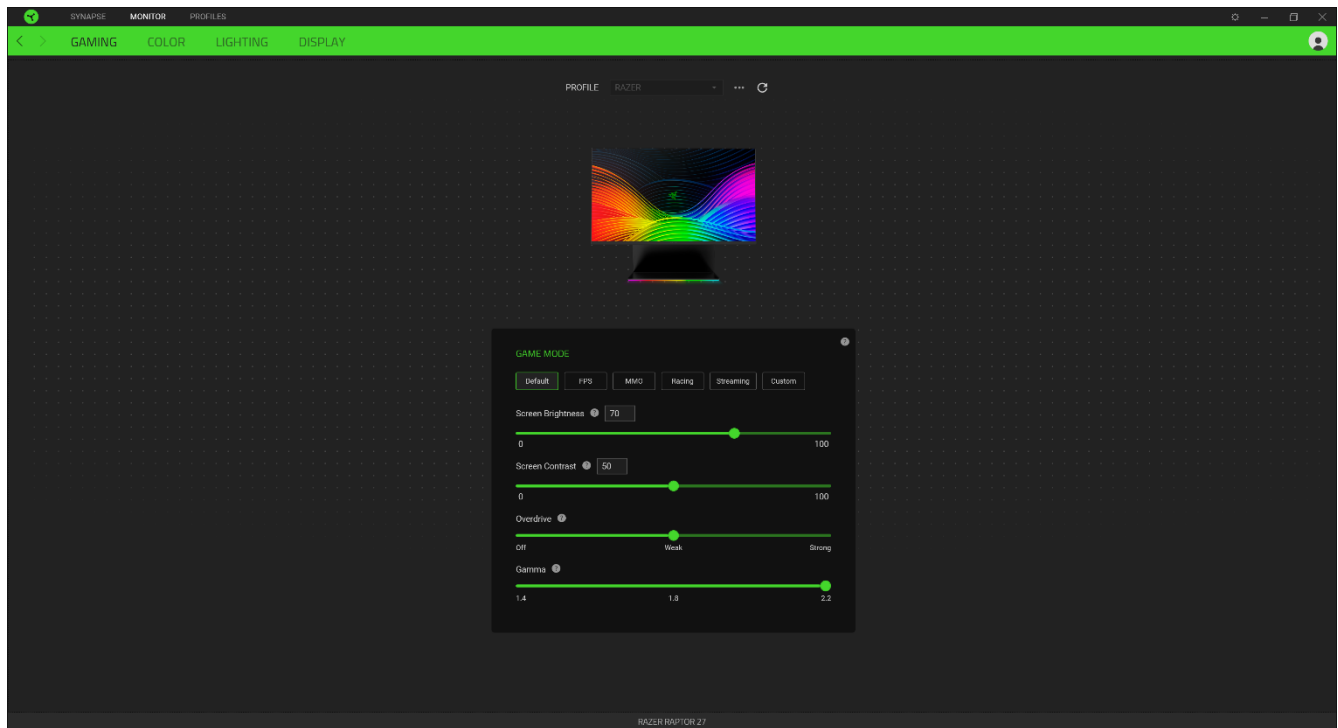

Profile

Profile is a data storage for keeping all your Razer peripheral's settings. By default, the profile name is based on your system's name. To add, rename, duplicate, or delete a profile, simply press the Miscellaneous button (●●●).

Game Mode

This feature allows you to easily choose and configure your monitor's visual settings. For optimum result, select the mode that best suits your preference, then customize the settings to further fine-tune.

Color Profile

The Color Profile subtab allows you to modify the color temperature of your monitor.

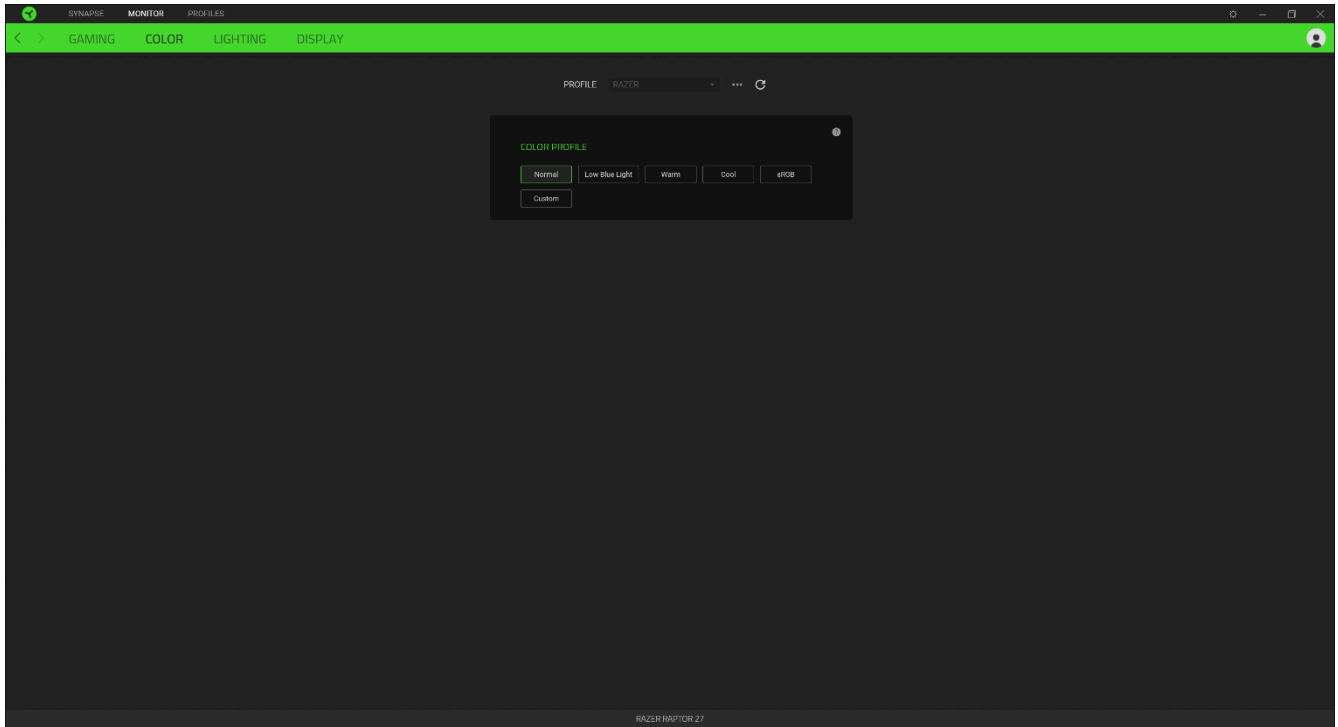

Lighting

The Lighting subtab enables you to change the settings for the underglow of your Razer Raptor 27.

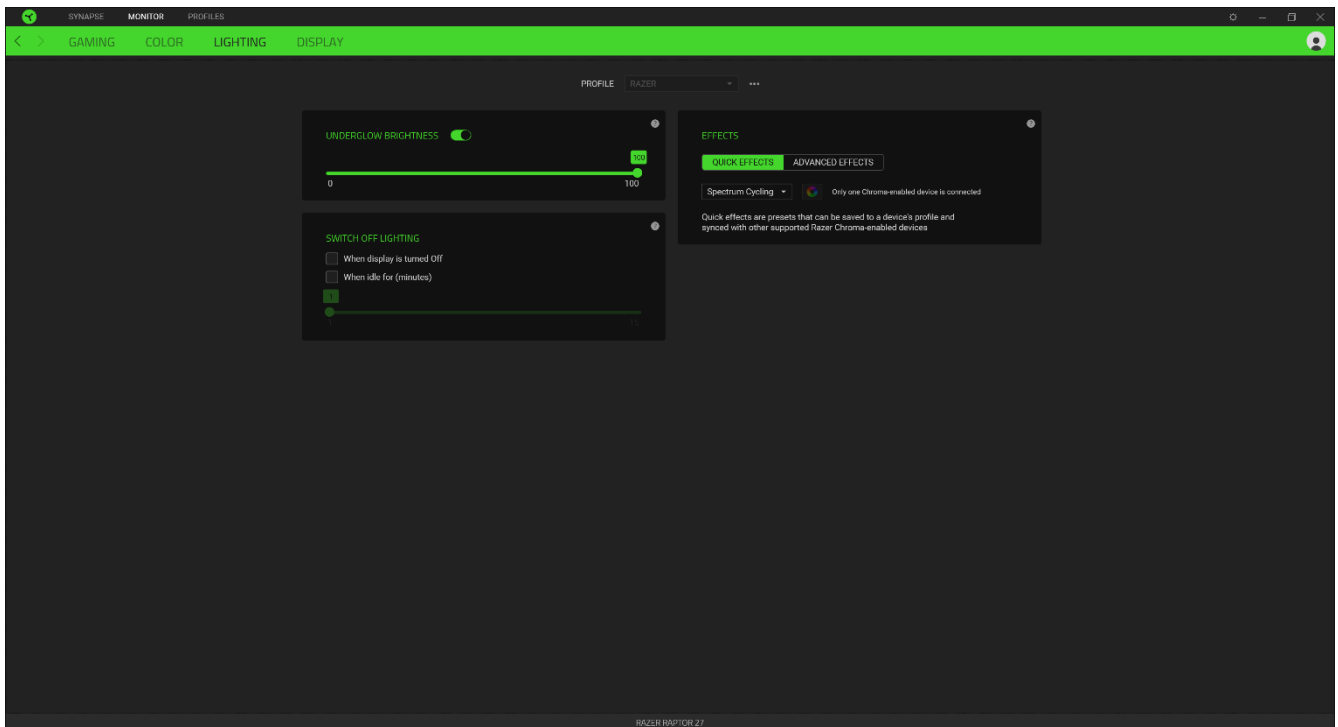

Underglow Brightness





You can turn off your Razer device's lighting by toggling the Underglow Brightness option or increase/decrease the luminance using the slider.

Switch Off Lighting

This is a power saving tool which allows you to disable your device's lighting in response to your system's display turning off and/or automatically power down when your Razer device has been idle for a set amount of time.

Effects

A number of quick effects can be selected and applied to your mouse's lighting, as listed here:

	Name	Description and in-depth options
	Audio meter	<p>The LEDs will light up according to the audio level with a default spectrum of colors</p> <ul style="list-style-type: none">▪ Color. Select the color pattern which will be used for the Low and High settings of the audio level. Customize these further by adding or deleting color stoppers.▪ Properties. Adjust Boost to control how quickly the current audio level will reach the High setting of the color pattern, and Decay for the Low setting.
	Breathing	<p>The lighting will fade in and out of the selected colors at your preferred duration</p> <ul style="list-style-type: none">▪ Color. Select up to two colors or have these randomized.▪ Properties. Adjust how fast the colors will fade in and out.▪ Playback. Set the effect to start randomly, upon pressing any key, or by pressing any selected key; and have it end after a set number of times or infinitely looped.
	Fire	<p>The LEDs will light up in warm colors to mimic the motion of flames</p> <ul style="list-style-type: none">▪ Color. Set a color for both the hot and cold regions of the effect.
	Spectrum cycling	<p>The lighting will cycle between 16.8 million colors indefinitely</p> <ul style="list-style-type: none">▪ Color. Select the color pattern for the effect. Customize these further by adding or deleting color stoppers.▪ Properties. Set how fast the effect will fade off from your LED(s).

	Starlight	<p>Each LED will have a chance of fading in and out at a random time and duration</p> <ul style="list-style-type: none"> ▪ Color. Select the color pattern or randomize the pattern for the effect. ▪ Properties. Set how frequent (Density) or how fast (Duration) the colors will fade in and out.
	Static	<p>The LEDs will remain lit in the selected color</p> <ul style="list-style-type: none"> ▪ Color. Select a color pattern which will be used for the effect.
	Wave	<p>The lighting will scroll in the direction selected</p> <ul style="list-style-type: none"> ▪ Color. Select the color pattern for the effect. Customize these further by adding or deleting color stoppers. ▪ Properties. Set how fast the lighting will scroll, adjust how wide the wave will be and which angle it will come from, control the delay between each wave, or have it split on the selected LEDs. ▪ Playback. Set the effect to start randomly, upon pressing any key or by pressing any selected key; and have it end after a set number of times or infinitely looped.

If you have other supported Razer Chroma-enabled devices, you can synchronize their quick effects with your Razer device by clicking the Chroma Sync button ().

 Only devices that support the selected lighting effect will synchronize. LED indicators are not customizable.

Advanced Effects

The Advanced Effects option allows you to choose a Chroma Effect you want to use on your Razer Chroma-enabled peripheral. To start making your own Chroma Effect, simply press the Chroma Studio button (). [Click here to learn more about the Chroma Studio](#)

Display

The Display subtab allows you to customize various hardware and visual options.

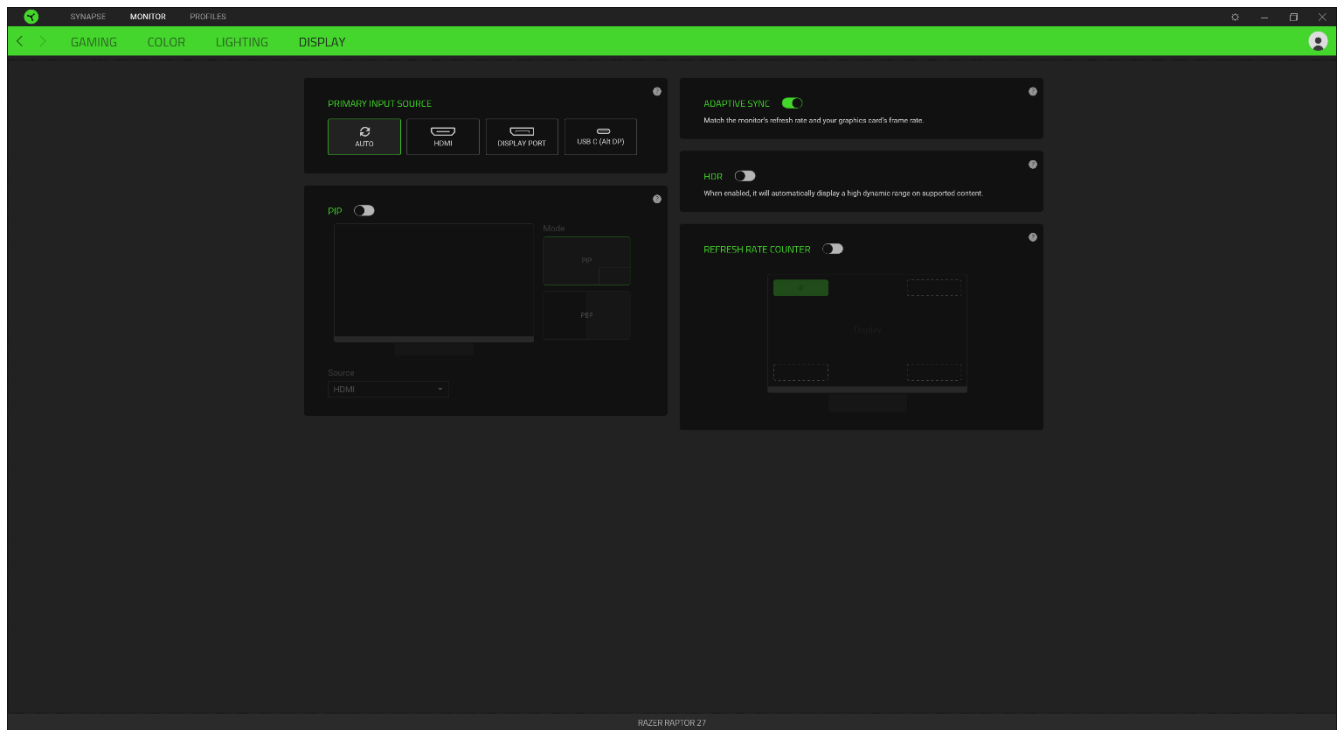

Primary Input Source

The Primary Input Source enables you to change the preferred video port for your monitor. If a particular input is selected, the display will not switch even when other devices are plugged into other ports.

PIP

The PIP allows you to activate the Picture-In-Picture function as well as other PIP-related settings.

Adaptive-Sync

Helps eliminate screen tearing when gaming on high frame rates.

HDR

Allows increased contrast ratio, improved color accuracy, and wider color gamut if the game or media content has HDR enabled.

Refresh Rate Counter

Shows the current refresh rate (Hz) of the monitor.

PROFILES TAB

The Profiles tab is a convenient way of managing all your profiles and linking them to your games and applications.

Devices

View which Razer device is using a specific profile using the Devices subtab.

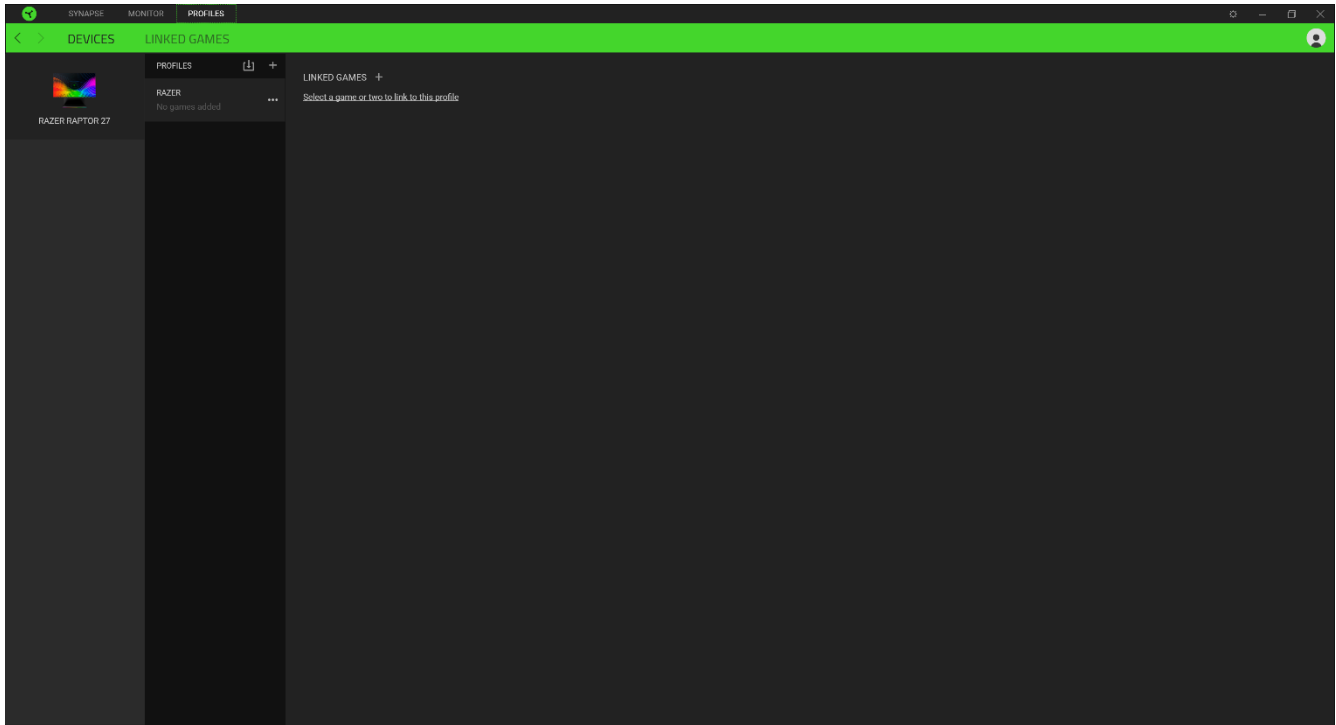

To create a new profile within the selected device, simply click the add button (+). To rename, duplicate, or delete a profile, simply press the Miscellaneous button (●●●). Each profile can be set to automatically activate when you run an application using the Link Games option.

Linked Games

The Linked Games subtab gives you the flexibility to add games, view peripherals that are linked to games, or search for added games. You can also sort games based on alphabetical order, last played, or most played. Added games will still be listed here even if it is not linked to a Razer device.

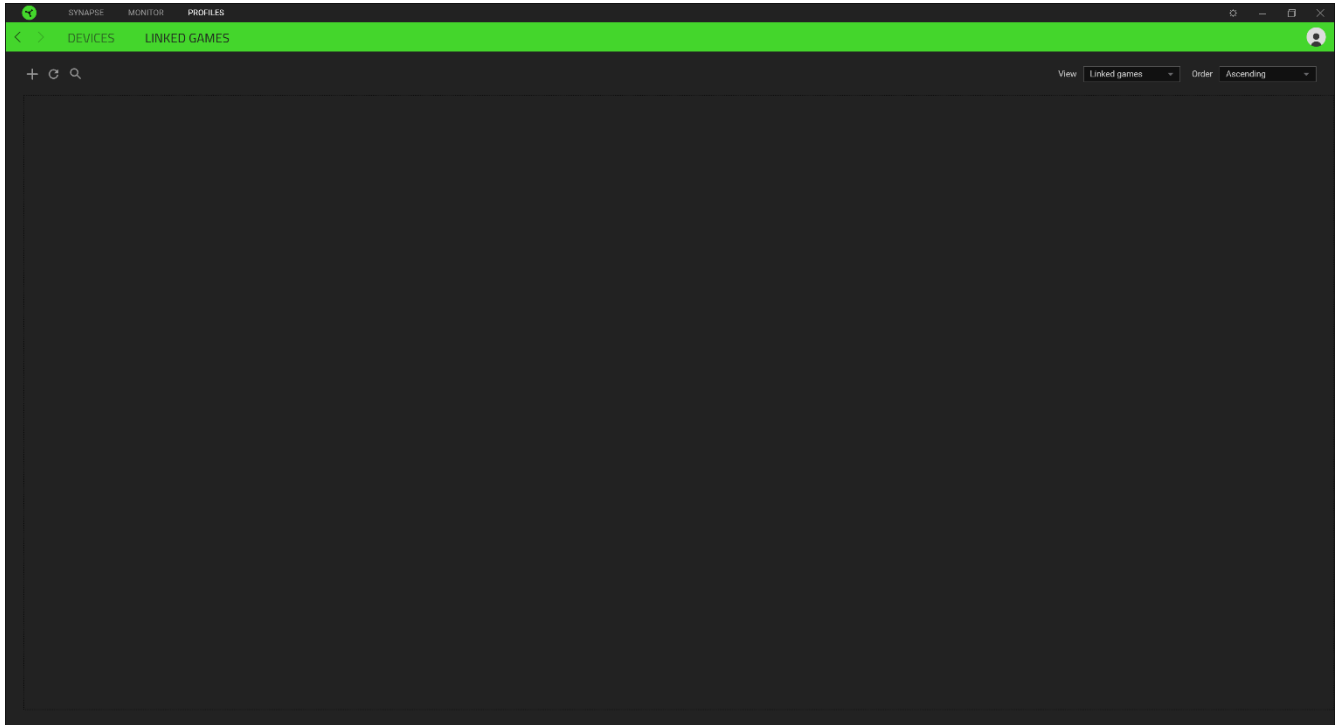

To link games to connected Razer devices or Chroma Effects, simply click on any game from the list, and then click **Select a device and its profile to launch automatically during gameplay** to select the Razer device or Chroma Effect it will link with.

Once linked, you may click on the Miscellaneous button (●●●) of the corresponding Chroma Effect or device to select a specific Chroma Effect or profile.

SETTINGS WINDOW

The Settings window, accessible by clicking the (⚙️) button on Razer Synapse 3, enables you to configure the startup behavior, change language, view your Razer device's master guide, or perform factory reset on any connected Razer device.

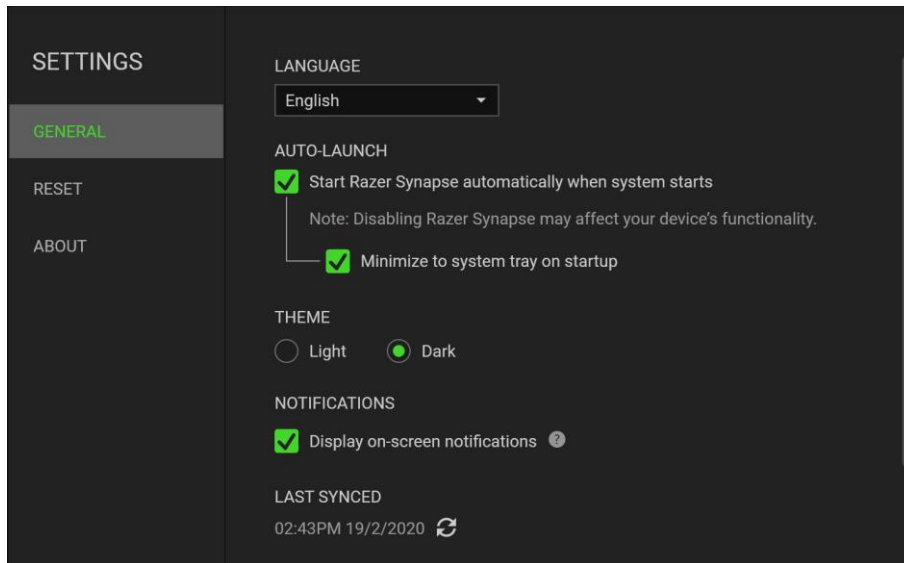

General tab

The default tab of the Settings window. The General tab enables you to change the software's display language, start-up behavior, and display theme; or view the master guide of all connected Razer devices. You may also manually sync your profiles to the cloud (↻) or view the master guide of all connected Razer devices.

Reset tab

The Reset tab allows you to perform a factory reset on all connected Razer devices with on-board memory and/or reset Razer Synapse 3 tutorials to acquaint yourself again with Razer Synapse 3's new features on its next launch.

i *By resetting a Razer device, all profiles stored on the selected device's on-board memory will be erased.*

About tab

The About tab displays brief software information, copyright statement, and provides relevant links for its terms of use. You may also use this tab to check for software updates, or as a quick access to Razer's social communities.

7. SAFETY AND MAINTENANCE

SAFETY GUIDELINES

In order to achieve maximum safety while using your Razer device, we suggest that you adopt the following guidelines:

Should you have trouble operating the device properly and troubleshooting does not work, unplug the device and contact the Razer hotline or go to support.razer.com for assistance.

Do not take apart the device (doing so will void your warranty) and do not attempt to operate it under abnormal current loads.

Keep the device away from liquid, humidity or moisture. Operate the device only within the specific temperature range of 0°C (32°F) to 40°C (104°F). Should the temperature exceed this range, unplug and/or switch off the device in order to let the temperature stabilize to an optimal level.

MAINTENANCE AND USE

The Razer device requires minimum maintenance to keep it in optimum condition. Once a month we recommend you unplug the device from the computer and clean it using a soft cloth or cotton swab to prevent dirt buildup. Do not use soap or harsh cleaning agents.

8. LEGALESE

COPYRIGHT AND INTELLECTUAL PROPERTY INFORMATION

©2021 Razer Inc. All rights reserved. Razer, the triple-headed snake logo, Razer logo, “For Gamers. By Gamers.”, and “Razer Chroma” logo are trademarks or registered trademarks of Razer Inc. and/or affiliated companies in the United States or other countries. All other trademarks and trade names are the property of their respective owners and other company and product names mentioned herein may be trademarks of their respective companies.

Windows and the Windows logo are trademarks of the Microsoft group of companies.

THX and the THX Logo are the property of THX Ltd., registered in the U.S. and other countries.

DisplayPort™ and the DisplayPort™ logo are trademarks owned by the Video Electronics Standards Association (VESA®) in the United States and other countries.

 The Adopted Trademarks HDMI, HDMI High-Definition Multimedia Interface, and the HDMI Logo are trademarks or registered trademarks of HDMI Licensing Administrator, Inc. in the United States and other countries.

Razer Inc. (“Razer”) may have copyright, trademarks, trade secrets, patents, patent applications, or other intellectual property rights (whether registered or unregistered) concerning the product in this guide. Furnishing of this guide does not give you a license to any such copyright, trademark, patent or other intellectual property right. The Razer Raptor 27 (the “Product”) may differ from pictures whether on packaging or otherwise. Razer assumes no responsibility for such differences or for any errors that may appear. Information contained herein is subject to change without notice.

LIMITED PRODUCT WARRANTY

For the latest and current terms of the Limited Product Warranty, please visit razer.com/warranty.

LIMITATION OF LIABILITY

Razer shall in no event be liable for any lost profits, loss of information or data, special, incidental, indirect, punitive or consequential or incidental damages, arising in any way out of distribution of, sale of, resale of, use of, or inability to use the Product. In no event shall Razer’s liability exceed the retail purchase price of the Product.

GENERAL

These terms shall be governed by and construed under the laws of the jurisdiction in which the Product was purchased. If any term herein is held to be invalid or unenforceable, then such term (in so far as it is invalid or unenforceable) shall be given no effect and deemed to be excluded without invalidating any of the remaining terms. Razer reserves the right to amend any term at any time without notice.