

## 4-Bay M.2 NVMe Enclosure - Thunderbolt™ 3 - PCIe



*Actual product may vary from photos*

### **User Manual** **SKU#: M2E4BTB3**

For the latest information and specifications visit  
[www.startech.com/M2E4BTB3](http://www.startech.com/M2E4BTB3)

# Compliance Statements

## FCC Compliance Statement

This equipment has been tested and found to comply with the limits for a Class B digital device, pursuant to part 15 of the FCC Rules. These limits are designed to provide reasonable protection against harmful interference in a residential installation. This equipment generates, uses and can radiate radio frequency energy and, if not installed and used in accordance with the instructions, may cause harmful interference to radio communications. However, there is no guarantee that interference will not occur in a particular installation. If this equipment does cause harmful interference to radio or television reception, which can be determined by turning the equipment off and on, the user is encouraged to try to correct the interference by one or more of the following measures:

- Reorient or relocate the receiving antenna
- Increase the separation between the equipment and receiver
- Connect the equipment into an outlet on a circuit different from that to which the receiver is connected
- Consult the dealer or an experienced radio/TV technician for help

## Industry Canada Statement

This Class B digital apparatus complies with Canadian ICES-003.

Cet appareil numérique de la classe [B] est conforme à la norme NMB-003 du Canada.

CAN ICES-3 (B)/NMB-3(B)

## Use of Trademarks, Registered Trademarks, and other Protected Names and Symbols

This manual may make reference to trademarks, registered trademarks, and other protected names and/or symbols of third-party companies not related in any way to StarTech.com. Where they occur these references are for illustrative purposes only and do not represent an endorsement of a product or service by StarTech.com, or an endorsement of the product(s) to which this manual applies by the third-party company in question. Regardless of any direct acknowledgement elsewhere in the body of this document, StarTech.com hereby acknowledges that all trademarks, registered trademarks, service marks, and other protected names and/or symbols contained in this manual and related documents are the property of their respective holders.

PHILLIPS® is a registered trademark of Phillips Screw Company in the United States or other countries.

# Safety Statements

## Safety Measures

- Wiring terminations should not be made with the product and/or electric lines under power.
- Cables (including power and charging cables) should be placed and routed to avoid creating electric, tripping or safety hazards.

## Mesures de sécurité

- Les terminaisons de câblage ne doivent pas être effectuées lorsque le produit et/ou les câbles électriques sont sous tension.
- Les câbles (y compris les câbles d'alimentation et de chargement) doivent être placés et acheminés de façon à éviter tout risque électrique, de chute ou de sécurité

## 安全対策

- 電源が入っている状態の製品または電線の終端処理を行わないでください。
- ケーブル(電源ケーブルと充電ケーブルを含む)は、適切な配置と引き回しを行い、電気障害やつまづきの危険性など、安全上のリスクを回避するようにしてください。

## Misure di sicurezza

- I terminali dei fili elettrici non devono essere realizzate con il prodotto e/o le linee elettriche sotto tensione.
- I cavi (inclusi i cavi di alimentazione e di ricarica) devono essere posizionati e stesi in modo da evitare pericoli di inciampo, rischi di scosse elettriche o pericoli per la sicurezza.

## Säkerhetsåtgärder

- Montering av kabelavslutningar får inte göras när produkten och/eller elledningarna är strömförda.
- Kablar (inklusive elkablar och laddningskablar) ska dras och placeras på så sätt att risk för snubblingsolyckor och andra olyckor kan undvikas.

# Table of Contents

<b>Compliance Statements</b> .....	<b>i</b>
<b>Safety Statements</b> .....	<b>ii</b>
<b>Product Diagram</b> .....	<b>1</b>
Side View .....	1
Top Angled View.....	2
Bottom View - Drive Bay Closed.....	3
Bottom View - Drive Bay Open.....	4
<b>Requirements</b> .....	<b>5</b>
<b>Installation</b> .....	<b>5</b>
Connect the Drives.....	5
(Optional) Connect a Thunderbolt 3 Peripheral.....	6
(Optional) Connect Displays .....	6
Powering the Enclosure.....	7
Connect the Enclosure to the Host Computer .....	7
<b>Operation</b> .....	<b>8</b>
Operating Temperature .....	8
Removing the Drives.....	8
Supported Video Resolutions.....	9
Daisy Chain Multiple Thunderbolt 3 Devices.....	10
Configure the Display Devices .....	10
<b>Warranty Information</b> .....	<b>11</b>

# Product Diagram

## Side View

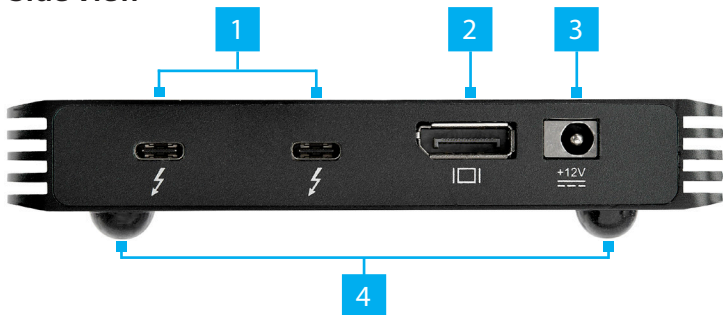

Component	Function
1 <b>Thunderbolt 3 Ports</b>	<ul style="list-style-type: none"> <li>Connect the <b>Enclosure</b> to the <b>Host Computer</b></li> <li>Connect <b>Thunderbolt 3 Peripherals</b></li> <li>Cascade the <b>Enclosure</b> to other <b>Enclosures</b></li> <li>Connect a <b>Thunderbolt 3 Enabled Display Device</b></li> </ul>
2 <b>DisplayPort Output Port</b>	<ul style="list-style-type: none"> <li>Connect a <b>DisplayPort Enabled Display Device</b></li> </ul>
3 <b>DC 12V Power Port</b>	<ul style="list-style-type: none"> <li>Connect a <b>Universal Power Adapter</b></li> </ul>
4 <b>Rubber Foot Pads</b>	<ul style="list-style-type: none"> <li>Prevent scratching</li> <li>Allow air to flow under the <b>Enclosure</b></li> </ul>

## Top Angled View



Component	Status	Indication
1	On	• <b>Enclosure</b> is receiving power from the <b>Universal Power Adapter</b>
	Off	• <b>Universal Power Adapter</b> is not connected
2		• Correspond with <b>M.2 Drives</b> 1-4
	On/ Flashing	• <b>M.2 Drive</b> activity detected
	Off	• <b>M.2 Drive</b> not connected • No <b>M.2 Drive</b> activity detected

## Bottom View - Drive Bay Closed

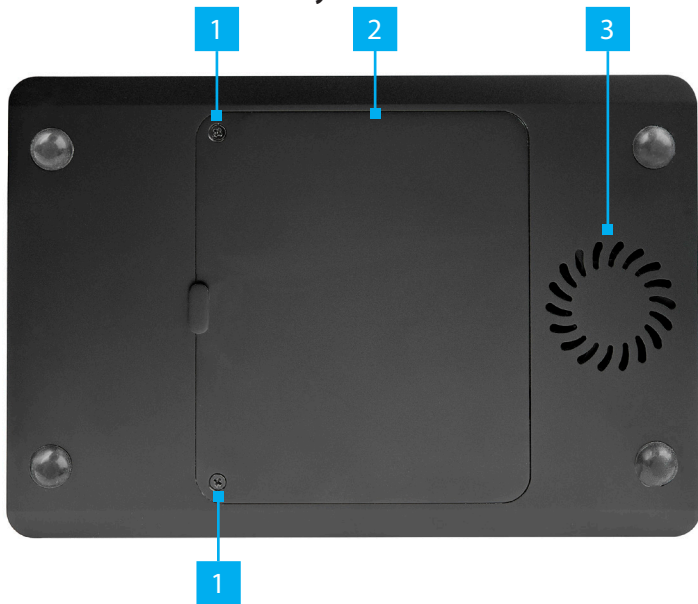

	Component	Function
1	<b>Drive Bay Screws</b>	<ul style="list-style-type: none"> <li>Secure the <b>Drive Bay Cover</b></li> </ul>
2	<b>Drive Bay Cover</b>	<ul style="list-style-type: none"> <li>Cover and protect the <b>M.2 Drives</b></li> </ul>
3	<b>Fan</b>	<ul style="list-style-type: none"> <li>Cool the <b>M.2 Drives</b></li> </ul>

To view manuals, videos, drivers, downloads, technical drawings, and more visit [www.startech.com/support](http://www.startech.com/support)

## Bottom View - Drive Bay Open

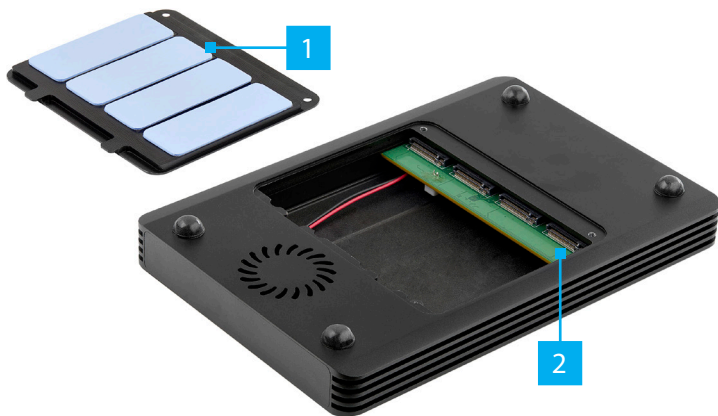

	Component	Function
1	<b>Thermal Pads</b>	<ul style="list-style-type: none"><li>Transfer heat from the <b>M.2 Drives</b> to the body of the <b>Enclosure</b></li></ul>
2	<b>M-Key Socket</b>	<ul style="list-style-type: none"><li>Connect up to 4 <b>M.2 Drives</b></li><li><b>Drives</b> are numbered to correspond with the <b>Drive Activity LED Indicators</b> (from left to right: 1, 2, 3, 4)</li></ul>



## Requirements

For the latest requirements please visit [www.startech.com/M2E4BTB3](http://www.startech.com/M2E4BTB3).

- Host Computer with a Thunderbolt 3 Port
- M-Key Connector Type, 22 x 80 mm (2280), M.2 Drive x (Up to) 4
- (Optional) Thunderbolt 3 Enabled Display Device x 1
- (Optional) Thunderbolt 3 Cable x 1
- (Optional) DisplayPort Enabled Display Device x 1
- (Optional) DisplayPort Cable x 1
- (Optional) Thunderbolt 3 Peripheral x 1
- (Optional) Thunderbolt 3 to DisplayPort Adapter Cable x 1

## Installation

### Connect the Drives

1. Turn the **Enclosure** upside down.
2. Remove the **Drive Bay Cover** on the bottom of the **Enclosure**:
  - Remove the two **Drive Bay Screws** using a **Phillips Head Screwdriver**.
  - Carefully flip the **Enclosure** to release the **Drive Bay Cover**.
3. Remove the **Holding Screw** for the **M.2 Drive** using a **Phillips Head Screwdriver**.
4. Slide the **M.2 Drive** into the **M-Key Socket** at a 45 degree angle.

**Note:** Ensure the **M.2 Drive** is properly seated, with the pins making full contact, before proceeding to the next step.

5. Gently press down on the **M.2 Drive** until the notch on the **M.2 Drive** is aligned with the hole for the **Holding Screw**.
6. While holding the **M.2 Drive** in place, secure the **M.2 Drive** by replacing the **Holding Screw** that was removed in step 3, using a **Phillips Head Screwdriver**.
7. Repeat steps 3-6 to instal the remaining **M.2 Drives**.
8. Replace the **Drive Bay Cover** that was removed in step 2.
9. Screw in the two **Drive Bay Screws** that were removed in step one, using a **Phillips Head Screwdriver**.

### **(Optional) Connect a Thunderbolt 3 Peripheral**

- Connect a **Thunderbolt 3 Cable** (sold separately) to one of the **Thunderbolt 3 Ports** on the **Enclosure** and to a **Thunderbolt 3 Port** on the **Thunderbolt 3 Peripheral**.

**--Or--**

- Connect a **Thunderbolt 3 Peripheral** directly to one of the **Thunderbolt 3 Ports** on the **Enclosure**.

### **(Optional) Connect Displays**

**Note:** Connect and setup the **DisplayPort Enabled Display Device** before connecting and setting up the **Thunderbolt 3 Enabled Display Device**.

## DisplayPort Enabled Display Device

- Connect a **DisplayPort Cable** (sold separately) to the **DisplayPort Output Port** on the **Enclosure** and to a **DisplayPort Input Port** on a **DisplayPort Enabled Display Device**.

## DisplayPort Enabled Display Device via Thunderbolt 3 Port

- Connect a **Thunderbolt 3 to DisplayPort Adapter Cable** to one of the **Thunderbolt 3 Ports** on the **Enclosure** and to a **DisplayPort Input Port** on a **DisplayPort Enabled Display Device**.

## Thunderbolt 3 Enabled Display Device

- Connect a **Thunderbolt 3 Cable** (included) to one of the **Thunderbolt 3 Ports** on the **Enclosure** and to a **Thunderbolt 3 Input Port** on a **Thunderbolt 3 Enabled Display Device**.

## Powering the Enclosure

1. Select the appropriate regional **Power Cord** and connect it to the **Universal Power Adapter**.
2. Connect the **Universal Power Adapter** to the **DC 12V Power Port** on the **Enclosure** and to an **AC Electrical Outlet**.

## Connect the Enclosure to the Host Computer

The **Thunderbolt 3 Ports** allow for a connection from the **Host Computer** to the **Enclosure**.

- Connect a **Thunderbolt 3 Cable** (included) to one of the **Thunderbolt 3 Ports** on the **Enclosure** and to a **Thunderbolt 3 Port** on the **Host Computer**.

## Operation

### Operating Temperature

Due to the high performance of Thunderbolt technology, Thunderbolt products sometimes generate more heat than traditional hardware. Therefore, it's normal for the **Enclosure** to warm up when in use. As such, it's recommended that the **Enclosure** is not placed on any part of the **Host Computer's** surface, as doing so will result in even higher temperatures.

These higher temperatures do not present a safety hazard to the user.

### Removing the Drives

**Notes:** After extended use the **M.2 Drives** may stick to the **Thermal Pads**. The labels of the **M.2 Drives** may become damaged during removal. This will not impact the performance of the **M.2 Drives**.

The **Thermal Pads** may leave residue on the **M.2 Drives** during removal.

1. Turn the **Enclosure** upside down.
2. Remove the **Drive Bay Cover** on the bottom of the **Enclosure**:
  - Remove the two **Drive Bay Screws** using a **Phillips Head Screwdriver**.
  - Carefully flip the **Enclosure** to release the **Drive Bay Cover**.
3. Remove the **Holding Screw** for the **M.2 Drive** using a **Phillips Head Screwdriver**.

- Slide the **M.2 Drive** out of the **M-Key Socket** at a 45 degree angle.

## Supported Video Resolutions

The **Enclosure** supports the following maximum resolutions:

Number of Displays	Ports	Maximum Resolution
1	DisplayPort Output Port	4096 x 2160p (60Hz)
1	Thunderbolt 3 Port	5120 x 2880 p (60Hz)
2	DisplayPort Output Port and Thunderbolt 3 Peripheral Port	4096 x 2160p (60Hz)
2	DisplayPort Output Port and Thunderbolt 3 Peripheral Port (USB-C to DisplayPort)	4096 x 2160p (60Hz)

- Depending on the configuration and the supported resolutions of the connected **Display Device(s)**, the **Enclosure** can support video resolutions lower than specified above.
- In a multi-display configuration, set the refresh rates on each of the connected **Display Devices** to the same values, otherwise the **Display Devices** might not properly display.

To view manuals, videos, drivers, downloads, technical drawings, and more visit [www.startech.com/support](http://www.startech.com/support)

- Video output capabilities are dependent on the video card and hardware specifications of the connected **Host Computer**.

## Daisy Chain Multiple Thunderbolt 3 Devices

Dual displays using multiple **Thunderbolt 3 Display Devices** can be used in a daisy chain configuration. For example, connect a **Thunderbolt 3 Display Device** to a **Thunderbolt 3 Port** on the **Enclosure**. Then connect another **Thunderbolt 3 Display Device** or a **Thunderbolt 3 Peripheral Device** through the first **Thunderbolt 3 Display Device**.

## Configure the Display Devices

Use the Windows operating system to adjust display settings for multiple **Display Devices**. The **Host Computer's** hardware must support dual external displays through its **Thunderbolt 3 Port**.

## Warranty Information

This product is backed by a two-year warranty.

For further information on product warranty terms and conditions, please refer to [www.startech.com/warranty](http://www.startech.com/warranty).

## Limitation of Liability

In no event shall the liability of StarTech.com Ltd. and StarTech.com USA LLP (or their officers, directors, employees or agents) for any damages (whether direct or indirect, special, punitive, incidental, consequential, or otherwise), loss of profits, loss of business, or any pecuniary loss, arising out of or related to the use of the product exceed the actual price paid for the product.

Some states do not allow the exclusion or limitation of incidental or consequential damages. If such laws apply, the limitations or exclusions contained in this statement may not apply to you.

## Hard-to-find made easy. At StarTech.com, that isn't a slogan. It's a promise.

StarTech.com is your one-stop source for every connectivity part you need. From the latest technology to legacy products — and all the parts that bridge the old and new — we can help you find the parts that connect your solutions.

We make it easy to locate the parts, and we quickly deliver them wherever they need to go. Just talk to one of our tech advisors or visit our website. You'll be connected to the products you need in no time.

Visit [www.startech.com](http://www.startech.com) for complete information on all StarTech.com products and to access exclusive resources and time-saving tools.

StarTech.com is an ISO 9001 Registered manufacturer of connectivity and technology parts. StarTech.com was founded in 1985 and has operations in the United States, Canada, the United Kingdom and Taiwan servicing a worldwide market.

### Reviews

Share your experiences using StarTech.com products, including product applications and setup, what you love about the products, and areas for improvement.

#### StarTech.com Ltd.

45 Artisans Cres.  
London, Ontario  
N5V 5E9  
Canada

FR: [startech.com/fr](http://startech.com/fr)

DE: [startech.com/de](http://startech.com/de)

#### StarTech.com LLP

2500 Creekside Pkwy.  
Lockbourne, Ohio  
43137  
U.S.A.

ES: [startech.com/es](http://startech.com/es)

NL: [startech.com/nl](http://startech.com/nl)

#### StarTech.com Ltd.

Unit B, Pinnacle  
15 Gowerton Rd.,  
Brackmills  
Northampton  
NN4 7BW  
United Kingdom

IT: [startech.com/it](http://startech.com/it)

JP: [startech.com/jp](http://startech.com/jp)